

Ανοιγόμενο Θερμομονωτικό Σύστημα  
Thermal Break Opening System

**WIPAC** **60** *Hybrid*

# ΑΝΟΙΓΟΜΕΝΟ ΘΕΡΜΟΜΟΝΩΤΙΚΟ ΣΥΣΤΗΜΑ THERMAL BREAK OPENING SYSTEM

Νέο ολοκληρωμένο σύστημα παραθύρων και πορτών, σχεδιασμένο για να καλύπτει τις τάσεις του σήμερα αλλά και το αύριο. Μειώνει την απαιτούμενη κτηριακή ενέργεια, προσφέρει αυξημένη πρόσβαση του φυσικού φωτός, εξαιρετικές επιδόσεις σε αντίξοες κλιματολογικές συνθήκες και ασφάλεια.

Διαθέτει μεγάλη γκάμα κατασκευαστικών επιλογών και συνδυάζεται άψογα σε σύνθετες κατασκευές με το συρόμενο σύστημα ESS 34 Hybrid. Ο συνδυασμός των δύο αυτών συστημάτων αποτελεί την ιδανική επιλογή για αντικαταστάσεις καλύπτοντας όλες τις απαιτούμενες προδιαγραφές.

Για πιο minimal γραμμές, δίνεται η δυνατότητα χρήσης του κρυφού φύλλου που μειώνει αισθητά την εμφανή επιφάνεια του πλαισίου.

EOS 60 Hybrid is the new aluminium system for windows and doors, specially designed to cover recent needs as also these of tomorrow. The system achieves significant reduction of building energy consumption and offers high level of natural lighting, outstanding performance in demanding climate conditions and security.

The system offers wide range of construction choices and can be perfectly combined with the sliding system ESS 34 Hybrid. Both systems are the perfect choice concerning the replacement of old systems covering all the necessary specifications.

For minimal design the use of hidden sash can cover the sash ideally, so as the outer joints are not visible.

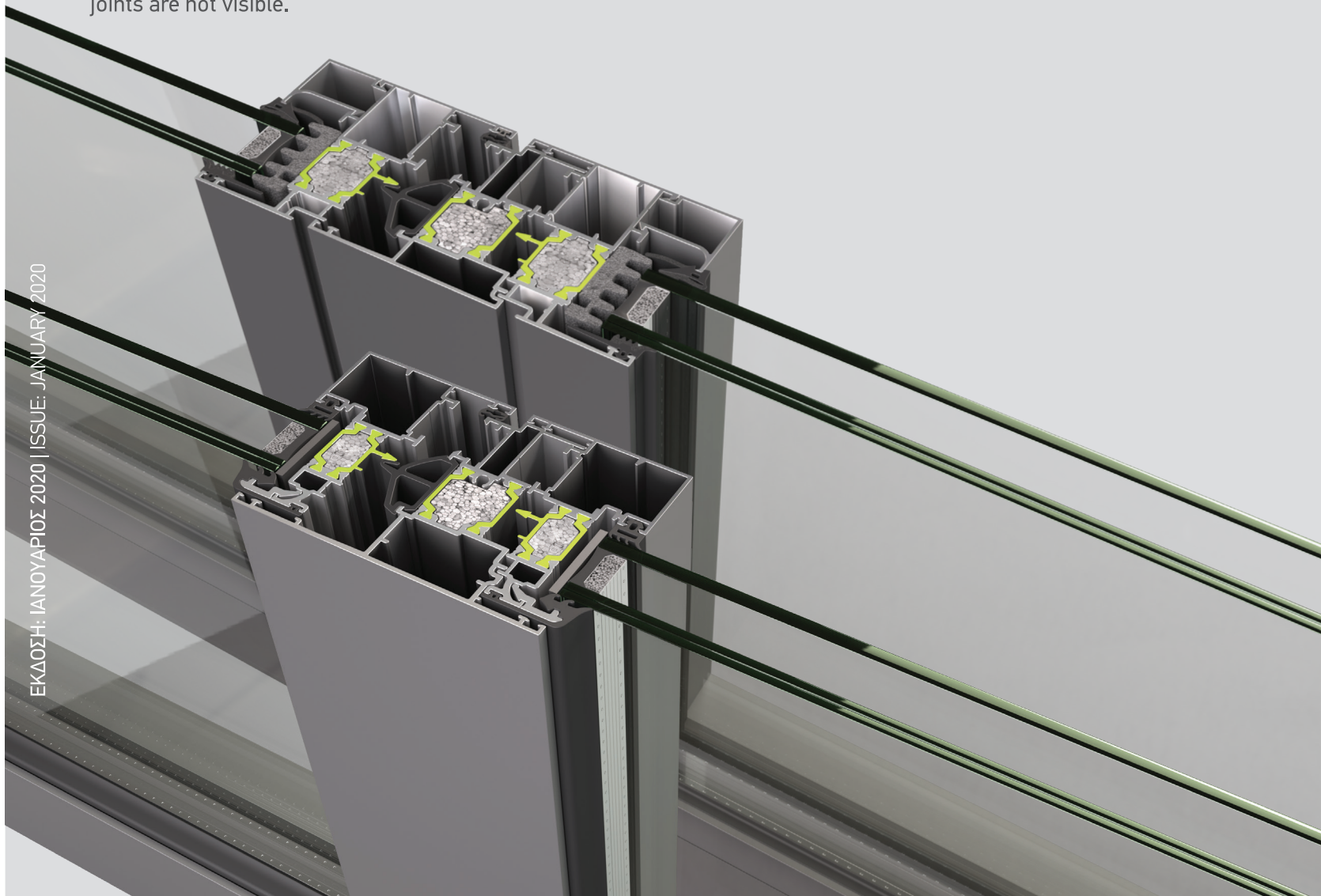

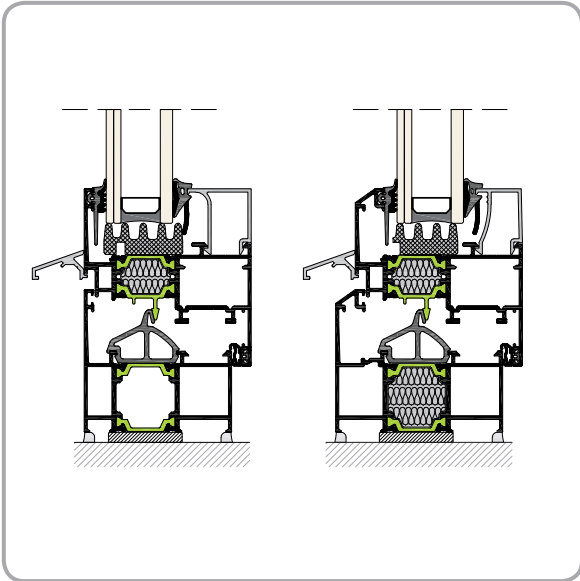

**ΒΑΣΙΚΑ ΧΑΡΑΚΤΗΡΙΣΤΙΚΑ ΣΥΣΤΗΜΑΤΟΣ**

1. Σχεδιασμός των προφίλ σε ίσια αλλά και σπαστή γραμμή.
2. Χρήση πολυαμιδίων 16 έως 24mm.
3. Προφίλ για χρήση περιμετρικού μηχανισμού κλειδώματος για αυξημένη ασφάλεια.
4. Επιλογή κρυφού φύλλου με έμφαση στο μίνιμαλ σχεδιασμό.
5. Αυξημένο επίπεδο θερμομόνωσης και ηχομόνωσης.
6. Δυνατότητα χρήσης διπλού ή τριπλού υαλοπινάκα έως 52mm.
7. Δυνατότητα κάλυψης όλων των απαιτήσεων βάσει KENAK.
8. Ιδανικό σύστημα για αντικαταστάσεις παλαιών κουφωμάτων.
9. Πρόσθετη μόνωση περιμετρικά των υαλοπινάκων.
10. Πρόσθετη μόνωση ανάμεσα των πολυαμιδίων.
11. Ελαστικά διπλής διέλασης, πλήρως ανακυκλώσιμα, για μέγιστη θερμομόνωση (EPDM-Expanded EPDM).
12. Δυνατότητα συνδυασμού με το σύστημα ESS 34 Hybrid για σύνθετες κατασκευές.

**BASIC CHARACTERISTICS**

1. Straight line and chamfered design profiles.
2. Use of 16 to 24mm polyamides.
3. Safety profiles using multilocking mechanism for maximum security.
4. Emphasis on minimal design with optional hidden sash profile.
5. Increased thermal and sound insulation.
6. Double or triple glass available up to 52mm.
7. Capacity to meet all requirements according to KENAK (Greek Regulation for the Energy Efficiency of Buildings).
8. Ideal system for windows replacement.
9. Extra insulation around the glass pane.
10. Extra insulation between the polyamides.
11. Full recyclable double-extrusion rubber (EPDM-Expanded EPDM) for maximum thermal insulation.
12. Can be combined with ESS 34 Hybrid system.

**ΤΥΠΟΛΟΓΙΕΣ ΚΑΤΑΣΚΕΥΩΝ**

- Πόρτες εισόδου.
- Ανοιγόμενα (με ανάκλιση ή χωρίς).
- Ανοιγόμενα παράθυρα με κρυφό φύλλο.
- Σταθερά Υαλοστάσια.
- Σύνθετες κατασκευές.

**TYPOLOGIES**

- Entrance doors.
- Opening windows (tilting or not).
- Opening windows with hidden sash.
- Fixed glazing.
- Composite typologies.

**ΤΕΧΝΙΚΑ ΧΑΡΑΚΤΗΡΙΣΤΙΚΑ**

Κράμα αλουμινίου:	<b>EN AW 6060 T6</b>	Aluminium alloy
Σκληρότητα:	<b>12 Webster</b>	Hardness
Ελάχιστο πάχος βαφής:	<b>75μm</b>	Minimum coating thickness
Πάχος των προφίλ:	<b>1,3-2mm</b>	Profile thickness
Ανοχές διαστάσεων σύμφωνα με:	<b>EN 12020-02</b>	Tolerance according to
Διαστάσεις κάσας:	<b>60mm x 53mm</b>	Dimensions of frame
Διαστάσεις φύλλου τζαμιού:	<b>68mm x 75mm</b>	Dimensions of glass sash
Πάχος υάλωσης φύλλου τζαμιού:	<b>16-52mm</b>	Glazing thickness
Πλάτος πολυαμιδίων:	<b>16-24mm</b>	Polyamide width
Συντελεστής θερμοπερατότητας πλαισίου:	<b>Uf=1,8-2,6W/m²K</b>	Thermal coefficient of frame
Μέγιστες διαστάσεις φύλλου (ΠxΥ):	<b>1,0m x 2,3m</b>	Maximum sash dimensions (WxH)
Μέγιστο βάρος φύλλου:	<b>150Kgr</b>	Maximum sash weight

**TECHNICAL CHARACTERISTICS**

Μετρήσεις Συντελεστή Θερμοπερατότητας Συστήματος  
System's Thermal Conductivity Calculations

1

**ADVANCED**

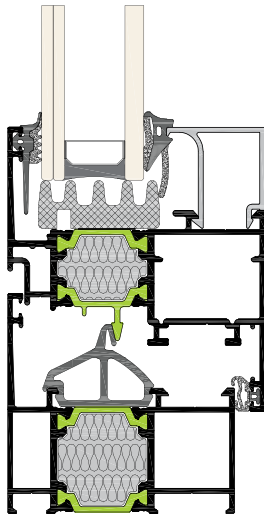

$U_f : 2,29 \text{ W/m}^2 \text{ K}$

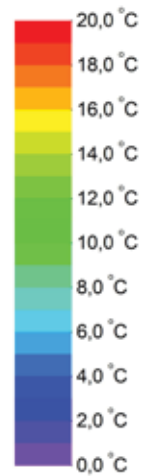
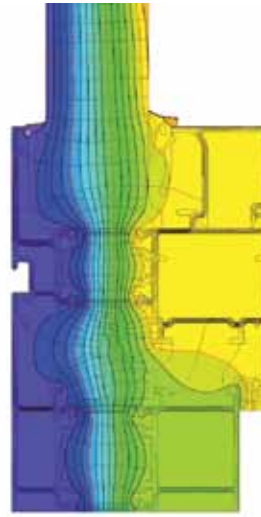

2

**STANDARD**

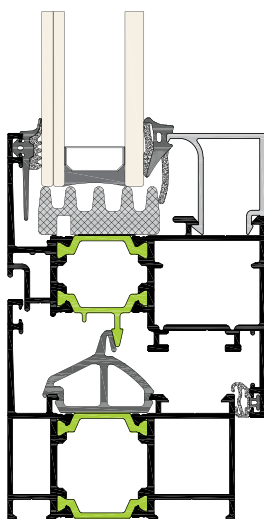

$U_f : 2,46 \text{ W/m}^2 \text{ K}$

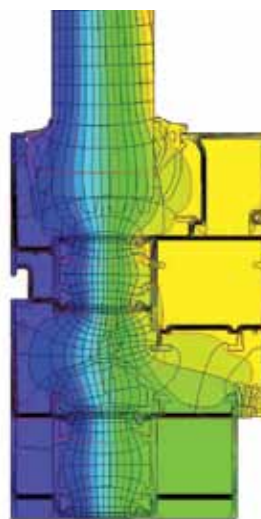



**1.1** Προφίλ  
Profiles

---

**1.2** Τομές  
Sections

---

**1.3** Κατεργασίες  
Machining

---

**1.4** Μέτρα Κοπής  
Cutting Instructions

---

**1.5** Εξαρτήματα  
Accessories

---

**1.6** Υπολογισμοί Αντοχής  
Static Diagrams

---

**1.7** Πιστοποιητικά  
Certificates



**1.1a**

Συνοπτικός Πίνακας Προφίλ  
General Profiles Table

<b>TH 57101</b>	Μήκος - Length 6,0 m	Θεωρ. Βάρος - Theor.Weight 1.081 gr/m
Κάσα - Frame		$I_x=5.45 \text{ cm}^4$ $I_{y(s)}=15.86 \text{ cm}^4$

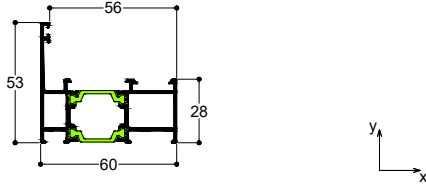

<b>TH 57102</b>	Μήκος - Length 6,0 m	Θεωρ. Βάρος - Theor.Weight 1.168 gr/m
Κάσα - Frame		$I_x=7.43 \text{ cm}^4$ $I_{y(s)}=17.29 \text{ cm}^4$

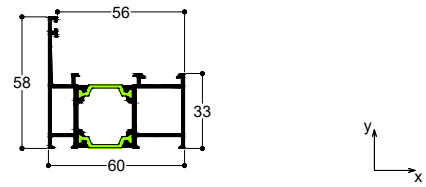

<b>TH 57103</b>	Μήκος - Length 6,0 m	Θεωρ. Βάρος - Theor.Weight 1.291 gr/m
Κάσα - Frame		$I_x=9.84 \text{ cm}^4$ $I_{y(s)}=23.44 \text{ cm}^4$

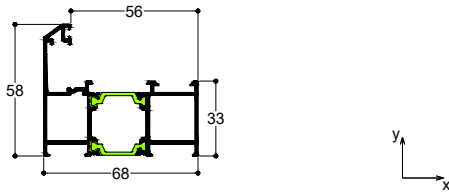

<b>TH 57104</b>	Μήκος - Length 6,0 m	Θεωρ. Βάρος - Theor.Weight 1.007 gr/m
Κάσα για Camera Europea Frame for C.E. Mechanism		$I_x=4.00 \text{ cm}^4$ $I_{y(s)}=14.43 \text{ cm}^4$

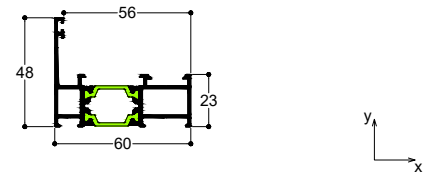

<b>TH 57105</b>	Μήκος - Length 6,0 m	Θεωρ. Βάρος - Theor.Weight 1.162 gr/m
Κάσα Αλλαγής Φοράς - Reversal Profile		$I_x=7.33 \text{ cm}^4$ $I_{y(s)}=16.08 \text{ cm}^4$

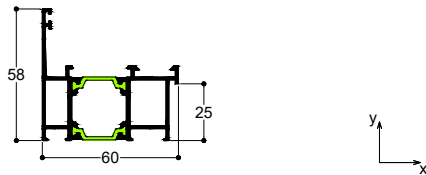

<b>TH 57106</b>	Μήκος - Length 6,0 m	Θεωρ. Βάρος - Theor.Weight 1.338 gr/m
Κάσα Κρυφού Φύλλου - Hidden Sash Frame		$I_x=14.31 \text{ cm}^4$ $I_{y(s)}=26.78 \text{ cm}^4$

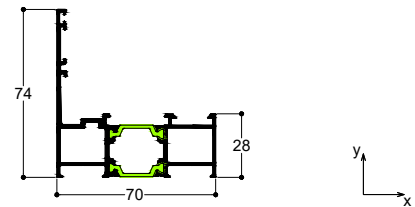

<b>TH 57107</b>	Μήκος - Length 6,0 m	Θεωρ. Βάρος - Theor.Weight 718 gr/m
Κατωκάσι - Threshold		$I_x=0.34 \text{ cm}^4$ $I_{y(s)}=9.98 \text{ cm}^4$

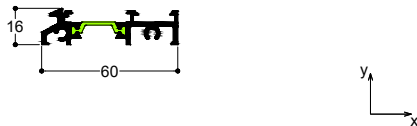

<b>TH 57108</b>	Μήκος - Length 6,0 m	Θεωρ. Βάρος - Theor.Weight 2.319 gr/m
Ενιαία Κάσα (Τζάμι-Σήτα-Πατζούρι) Wide Frame (Glass-Insect Screen-Shutter)		$I_x=20.36 \text{ cm}^4$ $I_{y(s)}=266.71 \text{ cm}^4$

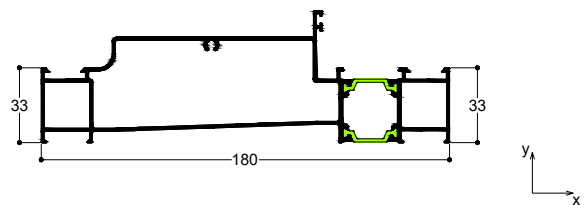

<b>TH 57109</b>	Μήκος - Length 6,0 m	Θεωρ. Βάρος - Theor.Weight 1.547 gr/m
Κάσα Πόρτας - Door Frame		$I_x=12.84 \text{ cm}^4$ $I_{y(s)}=41.99 \text{ cm}^4$

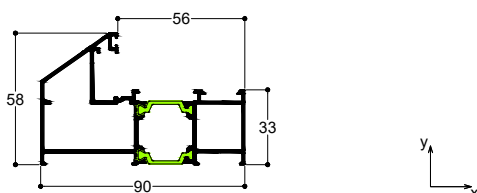

<b>TH 57110</b>	Μήκος - Length 6,0 m	Θεωρ. Βάρος - Theor.Weight 651 gr/m
Κατωκάσι - Threshold		$I_x=0.33 \text{ cm}^4$ $I_{y(s)}=5.39 \text{ cm}^4$

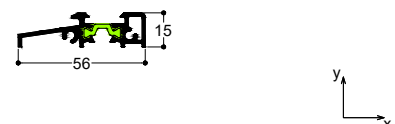



<b>TH 57112</b>	Μήκος - Length 6,0 m	Θεωρ. Βάρος - Theor.Weight 1.547 gr/m
-----------------	-------------------------	------------------------------------------

Κάσα - Frame  $I_x=22.41 \text{ cm}^4$   $I_{y(s)}=24.25 \text{ cm}^4$

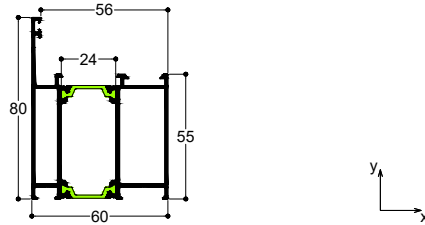

<b>TH 57113</b>	Μήκος - Length 6,0 m	Θεωρ. Βάρος - Theor.Weight 1.556 gr/m
-----------------	-------------------------	------------------------------------------

Κάσα πλατιά για τοποθέτηση σήτας  
Wide frame for combination with insect  
screen sash  $I_x=7.34 \text{ cm}^4$   $I_{y(s)}=66.17 \text{ cm}^4$

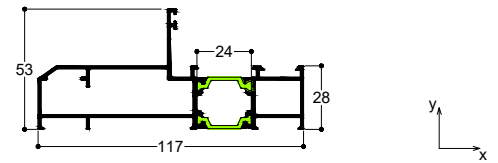

<b>TH 57201</b>	Μήκος - Length 6,0 m	Θεωρ. Βάρος - Theor.Weight 1.341 gr/m
-----------------	-------------------------	------------------------------------------

Φύλλο Τζαμιού - Glass Sash  $I_x=9.89 \text{ cm}^4$   $I_{y(s)}=26.35 \text{ cm}^4$

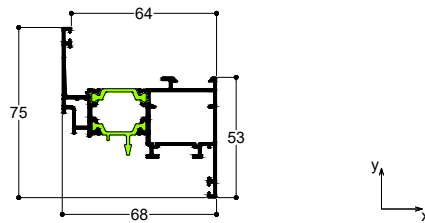

<b>TH 57203</b>	Μήκος - Length 6,0 m	Θεωρ. Βάρος - Theor.Weight 1.290 gr/m
-----------------	-------------------------	------------------------------------------

Φύλλο Τζαμιού - Glass Sash  $I_x=8.42 \text{ cm}^4$   $I_{y(s)}=25.18 \text{ cm}^4$

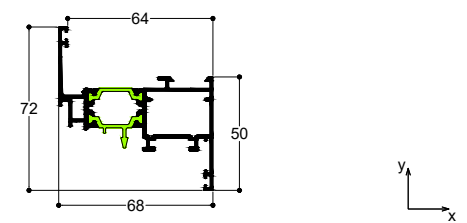

<b>TH 57205</b>	Μήκος - Length 6,0 m	Θεωρ. Βάρος - Theor.Weight 1.343 gr/m
-----------------	-------------------------	------------------------------------------

Φύλλο Τζαμιού - Glass Sash  $I_x=10.31 \text{ cm}^4$   $I_{y(s)}=26.21 \text{ cm}^4$

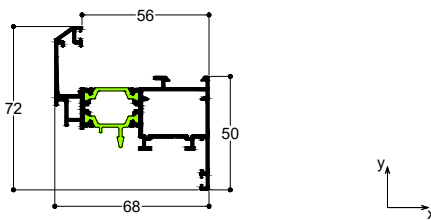

<b>TH 57206</b>	Μήκος - Length 6,5 m	Θεωρ. Βάρος - Theor.Weight 1.851 gr/m
-----------------	-------------------------	------------------------------------------

Φύλλο Πόρτας - Door Sash  $I_x=32.87 \text{ cm}^4$   $I_{y(s)}=38.10 \text{ cm}^4$

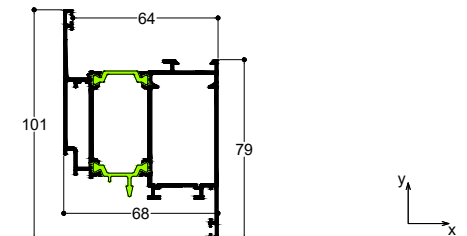

<b>TH 57208</b>	Μήκος - Length 6,5 m	Θεωρ. Βάρος - Theor.Weight 2.035 gr/m
-----------------	-------------------------	------------------------------------------

Φύλλο Πόρτας Εξωτερικά Ανοιγόμενο  
Outwards Opening Door Sash  $I_{x(s)}=40.51 \text{ cm}^4$   $I_y=38.07 \text{ cm}^4$

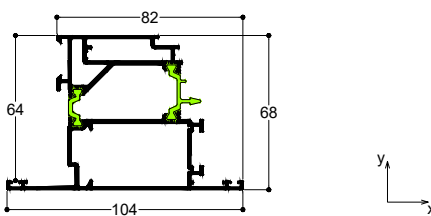

<b>TH 57210</b>	Μήκος - Length 6,0 m	Θεωρ. Βάρος - Theor.Weight 1.263 gr/m
-----------------	-------------------------	------------------------------------------

Κρυφό Φύλλο - Hidden Sash  $I_x=7.31 \text{ cm}^4$   $I_{y(s)}=22.38 \text{ cm}^4$

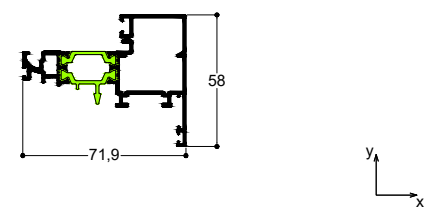

<b>TH 57211</b>	Μήκος - Length 6,0 m	Θεωρ. Βάρος - Theor.Weight 1.280 gr/m
-----------------	-------------------------	------------------------------------------

Κρυφό Φύλλο (Περμ. Μηχ.)  
Hidden Sash (ALU 16 Groove)  $I_x=6.87 \text{ cm}^4$   $I_{y(s)}=22.68 \text{ cm}^4$

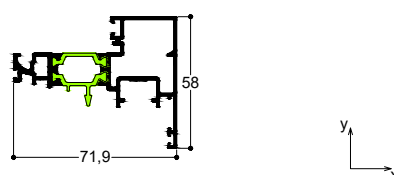

<b>TH 57213</b>	Μήκος - Length 6,0 m	Θεωρ. Βάρος - Theor.Weight 1.571 gr/m
-----------------	-------------------------	------------------------------------------

Φύλλο Παραθύρου Εξωτερικά Ανοιγόμενο  
Outwards Opening Window Sash  $I_x=15.05 \text{ cm}^4$   $I_{y(s)}=29.65 \text{ cm}^4$

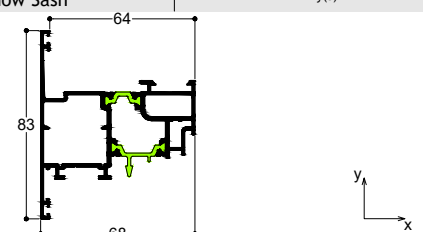

<b>TH 57231</b>	Μήκος - Length 6,0 m	Θεωρ. Βάρος - Theor.Weight 1.350 gr/m
-----------------	-------------------------	------------------------------------------

Φύλλο Τζαμιού (Περιμ. Μηχ.) Glass Sash (ALU 16 Groove)	$I_x=9.34 \text{ cm}^4$	$I_{y(s)}=26.56 \text{ cm}^4$
-----------------------------------------------------------	-------------------------	-------------------------------

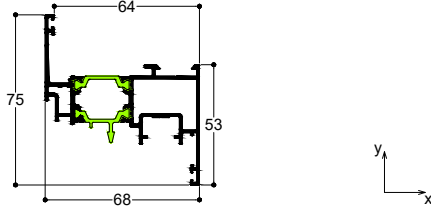

<b>TH 57232</b>	Μήκος - Length 6,0 m	Θεωρ. Βάρος - Theor.Weight 1.308 gr/m
-----------------	-------------------------	------------------------------------------

Φύλλο Τζαμιού (Περιμ. Μηχ.) Glass Sash (ALU 16 Groove)	$I_x=7.94 \text{ cm}^4$	$I_{y(s)}=25.54 \text{ cm}^4$
-----------------------------------------------------------	-------------------------	-------------------------------

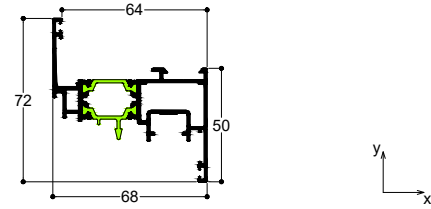

<b>TH 57233</b>	Μήκος - Length 6,0 m	Θεωρ. Βάρος - Theor.Weight 1.361 gr/m
-----------------	-------------------------	------------------------------------------

Φύλλο Τζαμιού (Περιμ. Μηχ.) Glass Sash (ALU 16 Groove)	$I_x=9.77 \text{ cm}^4$	$I_{y(s)}=26.60 \text{ cm}^4$
-----------------------------------------------------------	-------------------------	-------------------------------

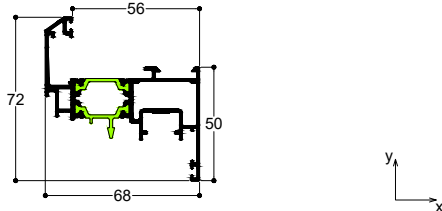

<b>TH 57234</b>	Μήκος - Length 6,5 m	Θεωρ. Βάρος - Theor.Weight 1.877 gr/m
-----------------	-------------------------	------------------------------------------

Φύλλο Πόρτας (Περιμ. Μηχ.) Door Sash (ALU 16 Groove)	$I_x=38.70 \text{ cm}^4$	$I_y=31.95 \text{ cm}^4$
---------------------------------------------------------	--------------------------	--------------------------

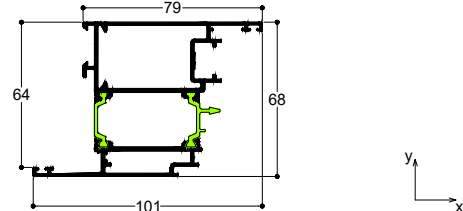

<b>TH 57235</b>	Μήκος - Length 6,5 m	Θεωρ. Βάρος - Theor.Weight 2.045 gr/m
-----------------	-------------------------	------------------------------------------

Φύλλο Πόρτας Εξωτερικά Ανοιγόμενο (Περιμ. Μηχ.) Outwards Opening Door Sash (ALU 16)	$I_{x(s)}=40.83 \text{ cm}^4$	$I_y=36.99 \text{ cm}^4$
-------------------------------------------------------------------------------------------	-------------------------------	--------------------------

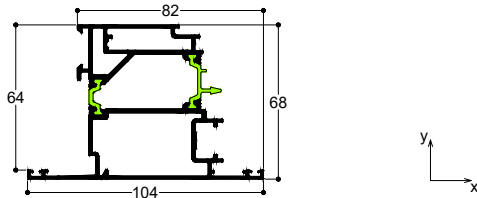

<b>TH 57301</b>	Μήκος - Length 6,0 m	Θεωρ. Βάρος - Theor.Weight 1.324 gr/m
-----------------	-------------------------	------------------------------------------

Μπινί (C.E.) - Adjoining Profile (C.E)	$I_x=8.95 \text{ cm}^4$	$I_{y(s)}=21.35 \text{ cm}^4$
----------------------------------------	-------------------------	-------------------------------

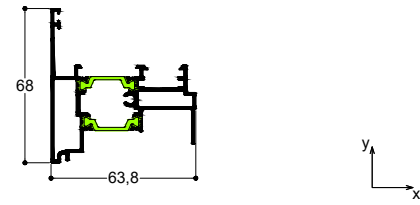

<b>TH 57302</b>	Μήκος - Length 6,0 m	Θεωρ. Βάρος - Theor.Weight 1.723 gr/m
-----------------	-------------------------	------------------------------------------

Μπινί Κρυφού Φύλλου Adjoining Profile for Hidden Sash	$I_{x(s)}=37.54 \text{ cm}^4$	$I_y=28.67 \text{ cm}^4$
----------------------------------------------------------	-------------------------------	--------------------------

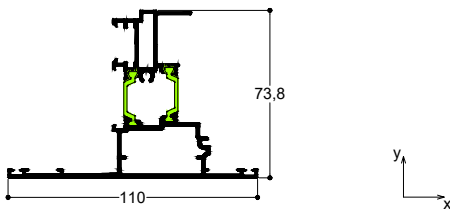

<b>TH 57331</b>	Μήκος - Length 6,0 m	Θεωρ. Βάρος - Theor.Weight 1.359 gr/m
-----------------	-------------------------	------------------------------------------

Μπινί (Περιμ. Μηχ.) Adjoining Profile (ALU 16 Groove)	$I_x=9.33 \text{ cm}^4$	$I_{y(s)}=20.92 \text{ cm}^4$
----------------------------------------------------------	-------------------------	-------------------------------

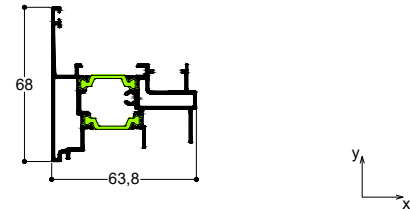

<b>TH 57332</b>	Μήκος - Length 6,0 m	Θεωρ. Βάρος - Theor.Weight 1.758 gr/m
-----------------	-------------------------	------------------------------------------

Μπινί Κρυφού Φύλλου (Περιμ. Μηχ.) Adjoining Profile for Hidden Sash (ALU 16 Groove)	$I_{x(s)}=37.35 \text{ cm}^4$	$I_y=29.05 \text{ cm}^4$
----------------------------------------------------------------------------------------	-------------------------------	--------------------------

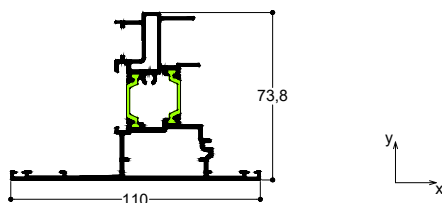

<b>TH 57402</b>	Μήκος - Length 6,0 m	Θεωρ. Βάρος - Theor.Weight 1.262 gr/m
-----------------	-------------------------	------------------------------------------

Χώρισμα φύλλου - Transom for window sash	$I_x=8.01 \text{ cm}^4$	$I_{y(s)}=24.15 \text{ cm}^4$
------------------------------------------	-------------------------	-------------------------------

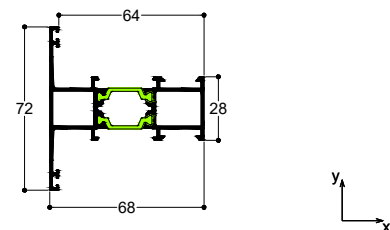

<b>TH 57403</b>	Μήκος - Length 6,0 m	Θεωρ. Βάρος - Theor.Weight 1.579 gr/m
-----------------	-------------------------	------------------------------------------

Χώρισμα Κρυφού Φύλλου Transom for Hidden Sash	$I_{x(s)}=32.44 \text{ cm}^4$	$I_{y(s)}=30.67 \text{ cm}^4$
--------------------------------------------------	-------------------------------	-------------------------------

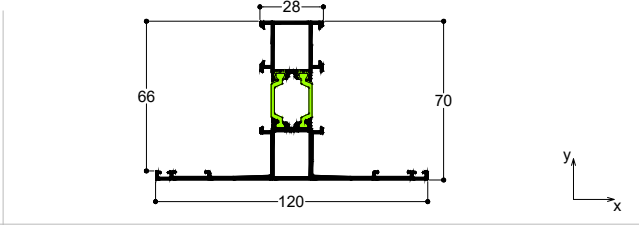

<b>TH 57405</b>	Μήκος - Length 6,0 m	Θεωρ. Βάρος - Theor.Weight 1.232 gr/m
-----------------	-------------------------	------------------------------------------

Χώρισμα Κάσας-Φύλλου Transom for Frame-Window Sash	$I_{x(s)}=9.38 \text{ cm}^4$	$I_{y(s)}=18.65 \text{ cm}^4$
-------------------------------------------------------	------------------------------	-------------------------------

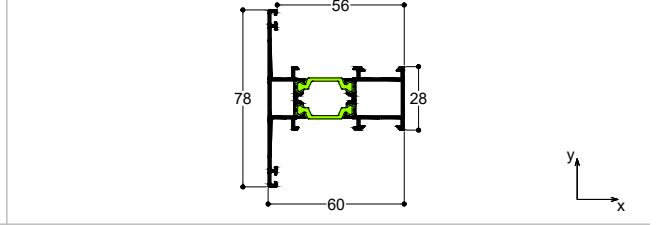

<b>TH 57406</b>	Μήκος - Length 6,0 m	Θεωρ. Βάρος - Theor.Weight 1.672 gr/m
-----------------	-------------------------	------------------------------------------

Χώρισμα - Transom	$I_x=31.65 \text{ cm}^4$	$I_{y(s)}=26.81 \text{ cm}^4$
-------------------	--------------------------	-------------------------------

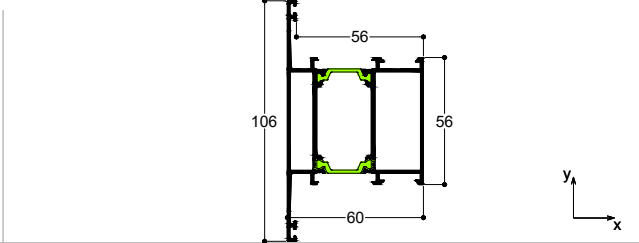

<b>TH 57409</b>	Μήκος - Length 6,0 m	Θεωρ. Βάρος - Theor.Weight 1.932 gr/m
-----------------	-------------------------	------------------------------------------

Ταμπλάς - Kickplate	$I_x=51.49 \text{ cm}^4$	$I_{y(s)}=41.00 \text{ cm}^4$
---------------------	--------------------------	-------------------------------

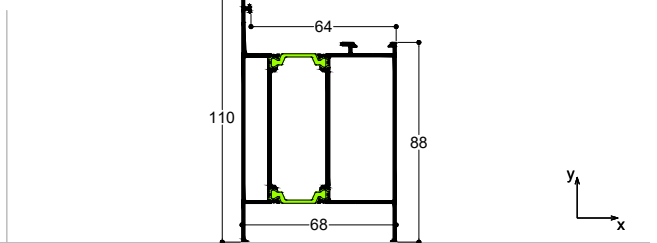

<b>TH 57603</b>	Μήκος - Length 6,0 m	Θεωρ. Βάρος - Theor.Weight 1.517 gr/m
-----------------	-------------------------	------------------------------------------

Συνδετικό Κασών - Frame Connector	$I_x=1.48 \text{ cm}^4$	$I_{y(s)}=75.07 \text{ cm}^4$
-----------------------------------	-------------------------	-------------------------------

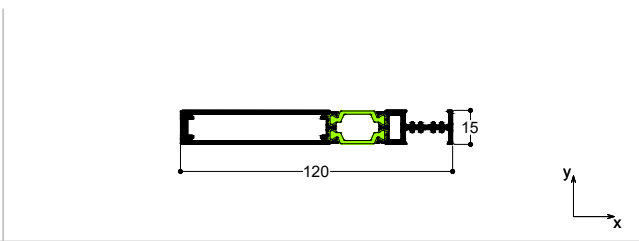

<b>TH 57604</b>	Μήκος - Length 6,0 m	Θεωρ. Βάρος - Theor.Weight 1.650 gr/m
-----------------	-------------------------	------------------------------------------

Γωνιακή Κολόνα - Corner Mullion	$I_{x(s)}=32.93 \text{ cm}^4$	$I_y=33.22 \text{ cm}^4$
---------------------------------	-------------------------------	--------------------------

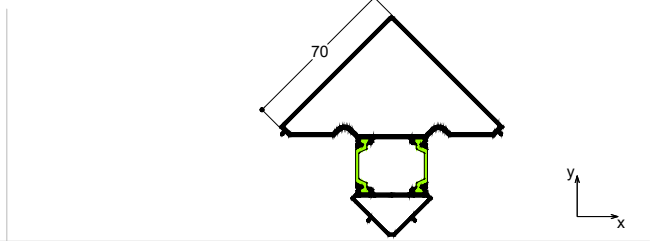

<b>TH 57623</b>	Μήκος - Length 6,0 m	Θεωρ. Βάρος - Theor.Weight 1.166 gr/m
-----------------	-------------------------	------------------------------------------

Πρόσθετο Προφίλ Στεγάνωσης Πόρτας Door Sash Add-On Profile	$I_x=3.01 \text{ cm}^4$	$I_{y(s)}=17.91 \text{ cm}^4$
---------------------------------------------------------------	-------------------------	-------------------------------

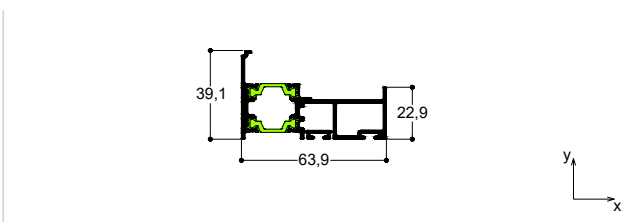

<b>TV 57601</b>	Μήκος - Length 6,0 m	Θεωρ. Βάρος - Theor.Weight 170 gr/m
-----------------	-------------------------	----------------------------------------

Νεροσταλλάκτης Φύλλου - Water Drip Profile for Sash		
-----------------------------------------------------	--	--

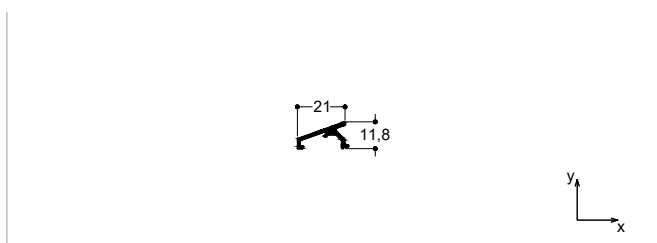

<b>TV 57602</b>	Μήκος - Length 6,0 m	Θεωρ. Βάρος - Theor.Weight 230 gr/m
-----------------	-------------------------	----------------------------------------

Τακάκι Στήριξης Υαλοπίνακα - Spacer Wedge for Glass		
-----------------------------------------------------	--	--

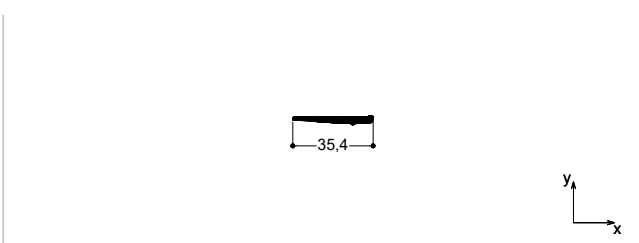

<b>TV 57605</b>	Μήκος - Length 6,0 m	Θεωρ. Βάρος - Theor.Weight 298 gr/m
-----------------	-------------------------	----------------------------------------

Προφίλ Στεγάνωσης Πόρτας Water Insulation Profile for Door		
---------------------------------------------------------------	--	--

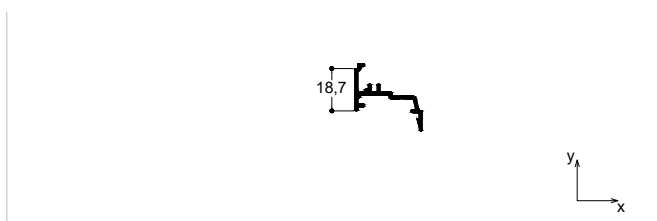

<b>TV 57625</b>	Μήκος - Length 6,0 m	Θεωρ. Βάρος - Theor. Weight 235 gr/m
-----------------	-------------------------	-----------------------------------------

Πρόσθετο Προφίλ Στεγάνωσης Πόρτας Door Sash Add-On Profile	$I_x=0,33 \text{ cm}^4$	$I_y=0,29 \text{ cm}^4$
---------------------------------------------------------------	-------------------------	-------------------------



<b>TV 00626</b>	Μήκος - Length 6,0 m	Θεωρ. Βάρος - Theor. Weight 117 gr/m
-----------------	-------------------------	-----------------------------------------

Συνδετικό Κασών - Frame Connector		
-----------------------------------	--	--



<b>TV 56521</b>	Μήκος - Length 6,0 m	Θεωρ. Βάρος - Theor. Weight 344 gr/m
-----------------	-------------------------	-----------------------------------------

Προσθήκη Κάσας Κρυφού Φύλλου - Frame Add-on for Hidden Sash		
-------------------------------------------------------------	--	--

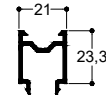

<b>TV 57627</b>	Μήκος - Length 6,0 m	Θεωρ. Βάρος - Theor. Weight 336 gr/m
-----------------	-------------------------	-----------------------------------------

Αρμολάμπτρο Gap Cover		
--------------------------	--	--

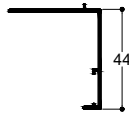

<b>TV 896</b>	Μήκος - Length 6,0 m	Θεωρ. Βάρος - Theor. Weight 688 gr/m
---------------	-------------------------	-----------------------------------------

Μπινί Πατζουριού Adjoining Profile for Shutter	$I_x=3,58 \text{ cm}^4$	$I_y=3,98 \text{ cm}^4$
---------------------------------------------------	-------------------------	-------------------------

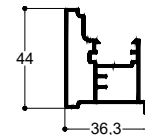

<b>TV 895</b>	Μήκος - Length 6,0 m	Θεωρ. Βάρος - Theor. Weight 820 gr/m
---------------	-------------------------	-----------------------------------------

Φύλλο Πατζουριού - Shutter Sash	$I_x=7,93 \text{ cm}^4$	$I_y=9,31 \text{ cm}^4$
---------------------------------	-------------------------	-------------------------

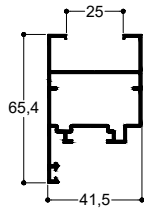

<b>TV 12503</b>	Μήκος - Length 6,0 m	Θεωρ. Βάρος - Theor. Weight 119 gr/m
-----------------	-------------------------	-----------------------------------------

Καπάκι Κολόνας Ενίσχυσης Cover for Reinforcement Mullion		
-------------------------------------------------------------	--	--



<b>TV 897</b>	Μήκος - Length 6,0 m	Θεωρ. Βάρος - Theor. Weight 553 gr/m
---------------	-------------------------	-----------------------------------------

Κάσα Πατζουριού - Frame for Shutter	$I_x=2,74 \text{ cm}^4$	$I_y=3,57 \text{ cm}^4$
-------------------------------------	-------------------------	-------------------------

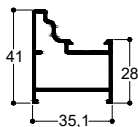

<b>TV 12603</b>	Μήκος - Length 6,0 m	Θεωρ. Βάρος - Theor. Weight 1.368 gr/m
-----------------	-------------------------	-------------------------------------------

Κολόνα Ενίσχυσης Reinforcement Mullion	$I_x=32,50 \text{ cm}^4$	$I_y=5,00 \text{ cm}^4$
-------------------------------------------	--------------------------	-------------------------

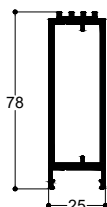

<b>TV 2080</b>	Μήκος - Length 6,0 m	Θεωρ. Βάρος - Theor. Weight 253 gr/m
----------------	-------------------------	-----------------------------------------

Πηχάκι Οβαλίνας - Clip for P3 Louver		
--------------------------------------	--	--

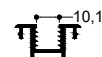



<b>TV 2266</b>	Μήκος - Length 6,0 m	Θεωρ. Βάρος - Theor. Weight 777 gr/m
Χώρισμα Πατζουριού Transom for Shutter Sash		
		$I_x=7.06\text{cm}^4$ $I_y=4.57\text{cm}^4$

<b>TV 5040</b>	Μήκος - Length 6,0 m	Θεωρ. Βάρος - Theor. Weight 119 gr/m
Αντάπτορας TV 57502 Adapter for TV 57502		

<b>TV 5067</b>	Μήκος - Length 6,0 m	Θεωρ. Βάρος - Theor. Weight 220 gr/m
Τελείωμα Οβαλίνης Ασφαλείας Additional Ending for Security Fixed Louver		

<b>PER 232</b>	Μήκος - Length 6,0 m	Θεωρ. Βάρος - Theor. Weight 381 gr/m
Ρυθμιστής Κινητής Περισίδας Regulator of Movable Louver		

<b>PER 250</b>	Μήκος - Length 6,0 m	Θεωρ. Βάρος - Theor. Weight 547 gr/m
Φυλλαράκι Πατζουριού (Κρινάκι) Fixed Louver Profile		
7.6 Kgr/m <sup>2</sup>		14 τεμ./m

<b>TV 5050</b>	Μήκος - Length 6,0 m	Θεωρ. Βάρος - Theor. Weight 150 gr/m
Ντίτζα Κίνησης - Mechanism Rod		

<b>TV 5066</b>	Μήκος - Length 6,0 m	Θεωρ. Βάρος - Theor. Weight 421 gr/m
Οβαλίνα Ασφαλείας - Fixed Louver Profile		
		$I_x=4,19\text{cm}^4$ $I_y=0,23\text{cm}^4$
<b>P3</b>	Μήκος - Length 6,0 m	Θεωρ. Βάρος - Theor. Weight 368 gr/m
Οβαλίνα - Fixed Louver Profile		
		$I_x=0,23\text{cm}^4$ $I_y=3,22\text{cm}^4$

<b>PER 231</b>	Μήκος - Length 6,0 m	Θεωρ. Βάρος - Theor. Weight 317 gr/m
Προσθήκη Τελειώματος Κινητής Περισίδας Additional Ending Profile for Movable Louver		

<b>PER 233</b>	Μήκος - Length 5,0 m	Θεωρ. Βάρος - Theor. Weight 525 gr/m
Φυλλαράκι Κινητής Περισίδας Profile for Movable Louver		

<b>PER 260</b>	Μήκος - Length 6,0 m	Θεωρ. Βάρος - Theor. Weight 620 gr/m
Φυλλαράκι Πατζουριού (Κρινάκι) Fixed Louver Profile		
6.8 Kgr/m <sup>2</sup>		11 τεμ./m

**PER 270**

Μήκος - Length  
6,0 m

Θεωρ. Βάρος - Theor. Weight  
441 gr/m

Φυλλαράκι Πατζουριού (Τουλίπα)  
Fixed Louver Profile

7,1 Kgr/m<sup>2</sup>

16 τεμ./m

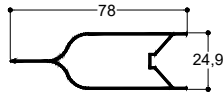

**PER 300**

Μήκος - Length  
6,0 m

Θεωρ. Βάρος - Theor. Weight  
730 gr/m

Φυλλαράκι Πατζουριού  
Fixed Louver Profile

7,3 Kgr/m<sup>2</sup>

10 τεμ./m

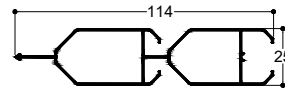

**PER 320**

Μήκος - Length  
6,0 m

Θεωρ. Βάρος - Theor. Weight  
408 gr/m

Φυλλαράκι Πατζουριού  
Fixed Louver Profile

6.15 Kgr/m<sup>2</sup>

15 τεμ./m

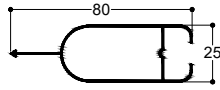

**1.1b**

Διατομές 1:1

Profiles 1:1

**TH 57104**

6,0 m 1.007 gr/m

Κάσα για Camera  
Europea

Frame for C.E.  
Mechanism

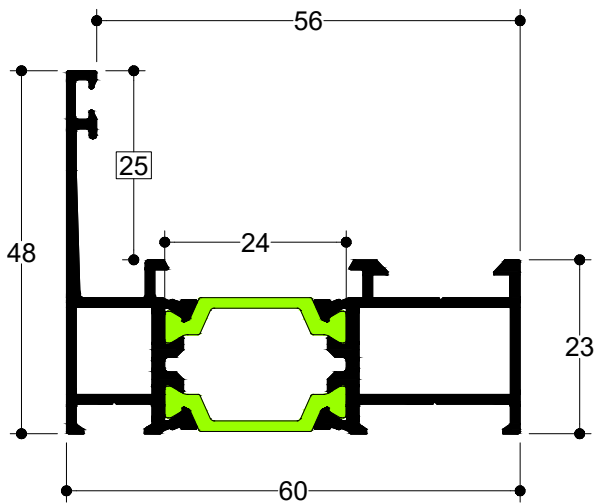

**TH 57101**

6,0 m 1.081 gr/m

Κάσα

Frame

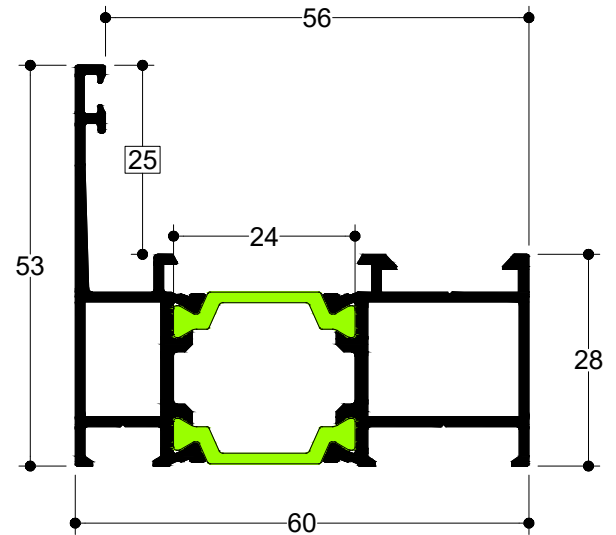

**TH 57102**

6,0 m 1.168 gr/m

Κάσα

Frame

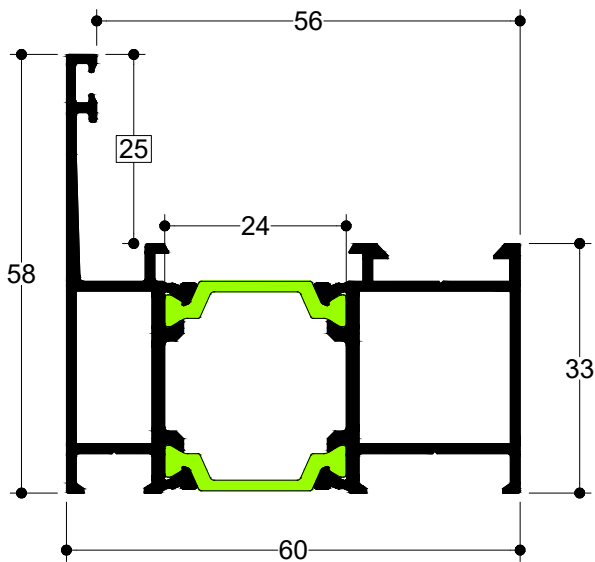

**TH 57112**

6,0 m 1.547 gr/m

Κάσα

Frame

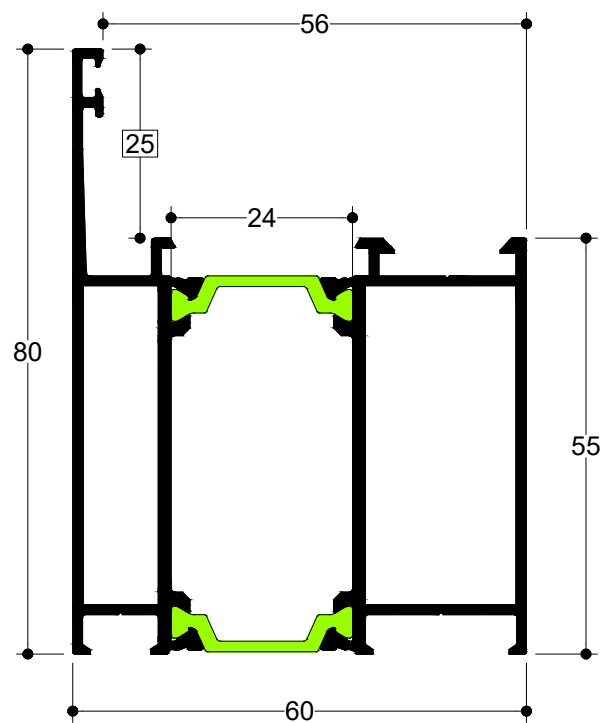



**TH 57103**

6,0 m | 1.291 gr/m

Κάσα  
Frame

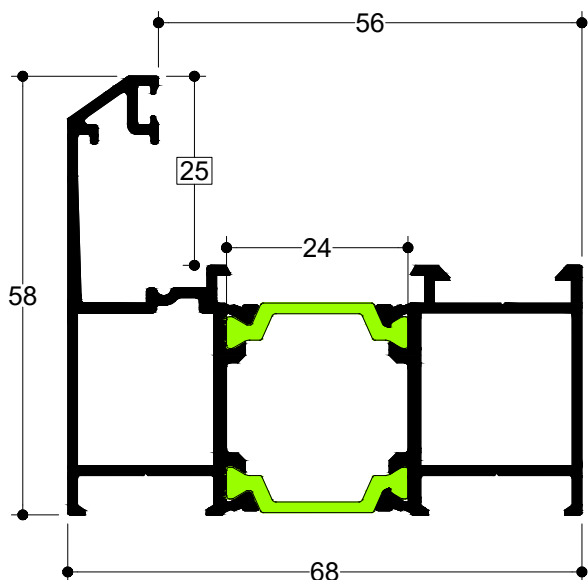

**TH 57109**

6,0 m | 1.547 gr/m

Κάσα Πόρτας  
Door Frame

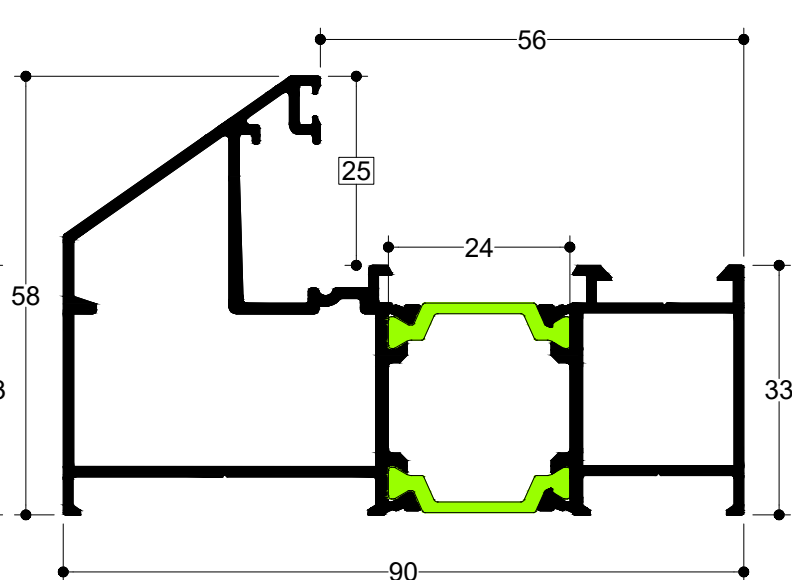

**TH 57108**

6,0 m | 2.319 gr/m

Ενιαία Κάσα  
(Τζάμι-Σήτα-Πατζούρι)  
Wide Frame  
(Glass-Insect Screen-Shutter)

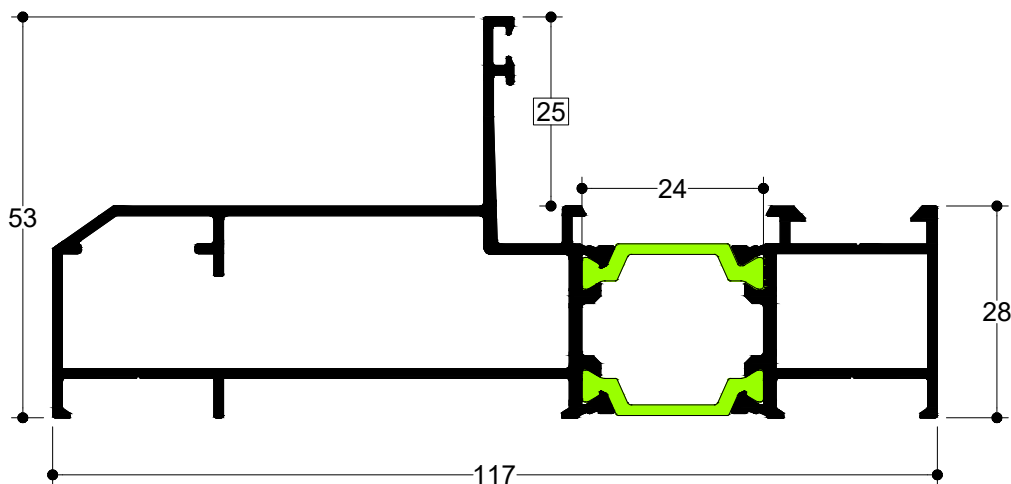
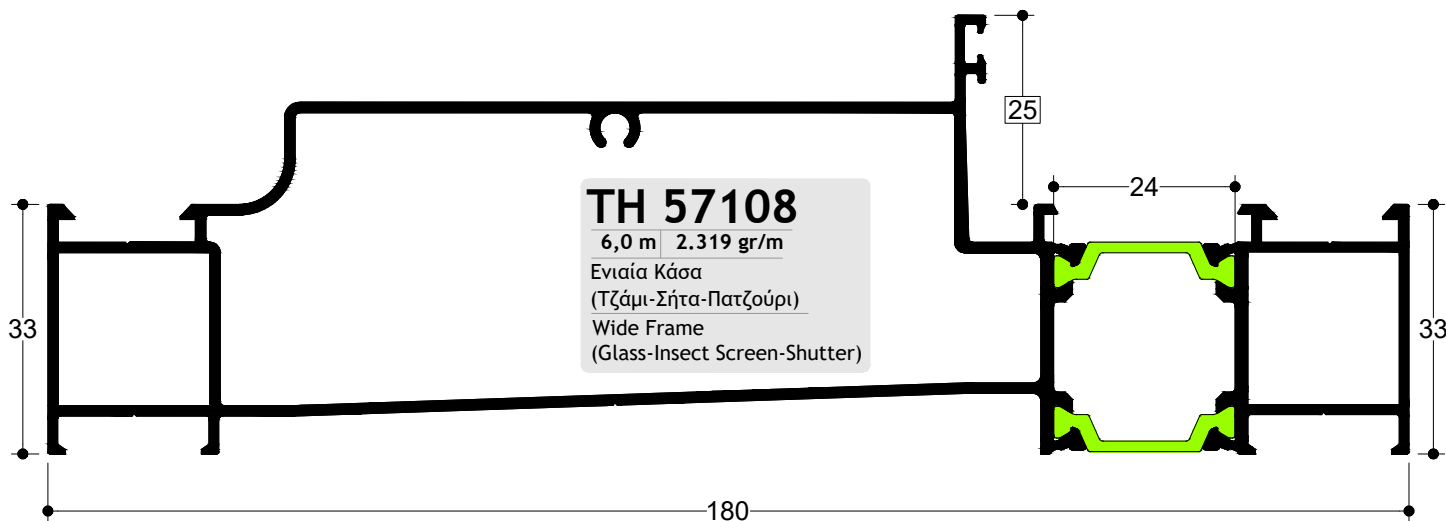

**TH 57113**

6,0 m | 1.556 gr/m

Κάσα πλατιά για τοποθέτηση  
σήτας

Wide Frame for combination  
with insect screen sash

Συνδυάζεται με επάλληλο οδηγό με  
σήτα της σειράς ESS-34 (TH 12119)  
Combined with double successive  
rail with insect screen (TH 12119)

**TH 57201**

6,0 m 1.341 gr/m  
Φύλλο Τζαμιού  
Glass Sash

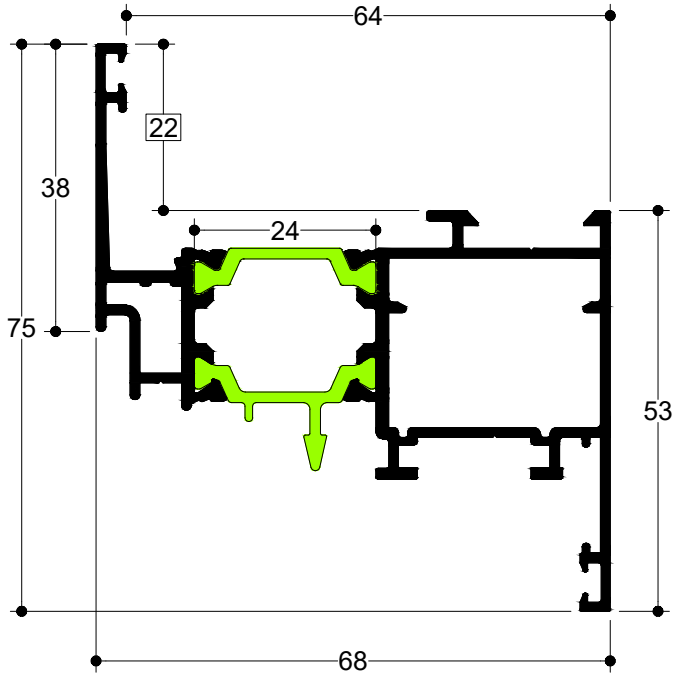

**TH 57203**

6,0 m 1.290 gr/m  
Φύλλο Τζαμιού  
Glass Sash

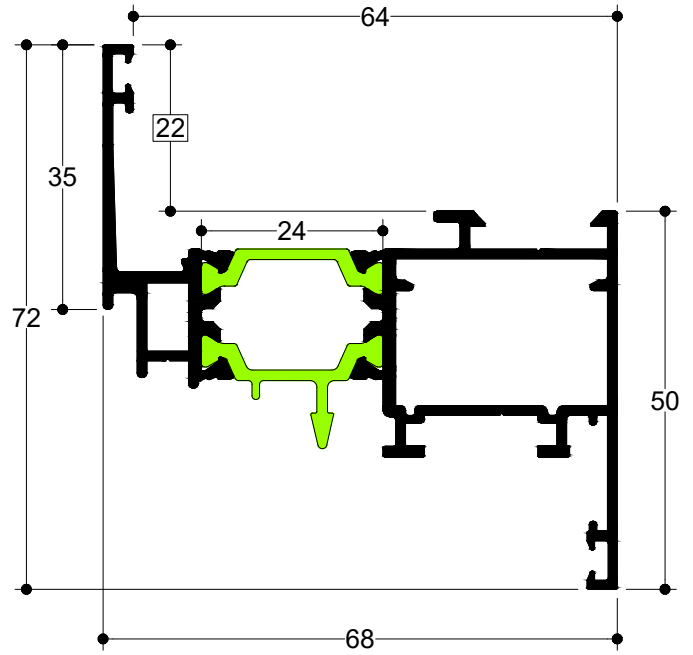

**TH 57205**

6,0 m 1.343 gr/m  
Φύλλο Τζαμιού  
Glass Sash

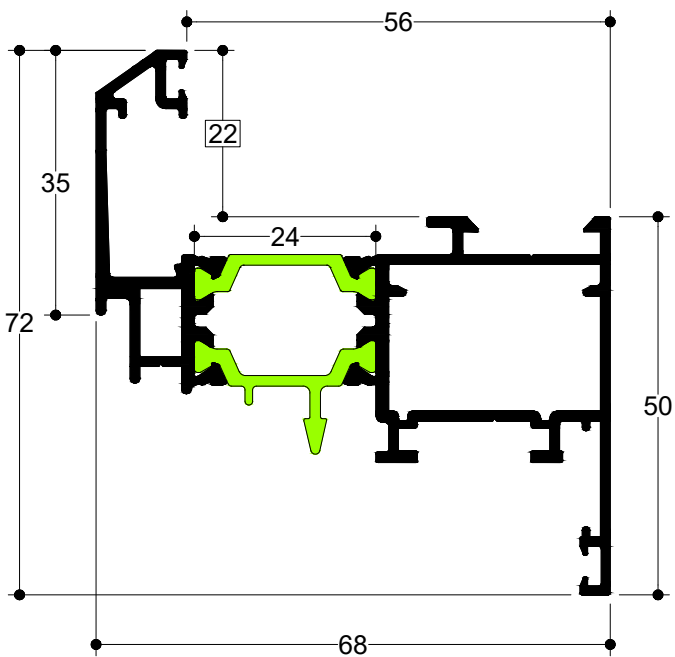

**TH 57301**

6,0 m 1.324 gr/m  
Μπινί  
Adjoining Profile

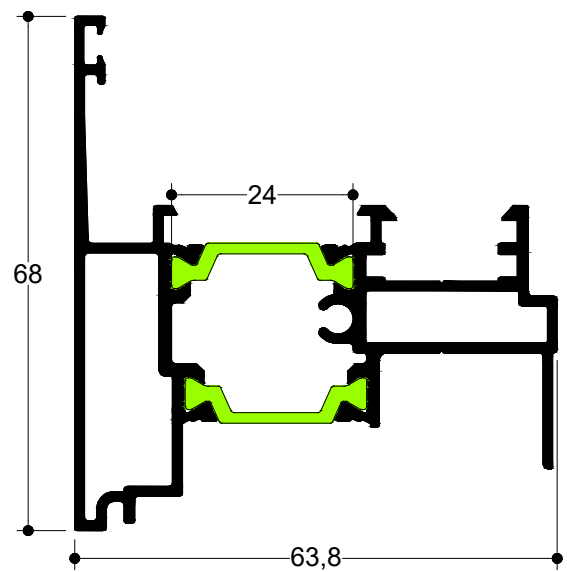

**TH 57231**

6,0 m | 1.350 gr/m  
Φύλλο Τζαμιού  
(Περμ. Μηχ.)  
Glass Sash  
(ALU 16 Groove)

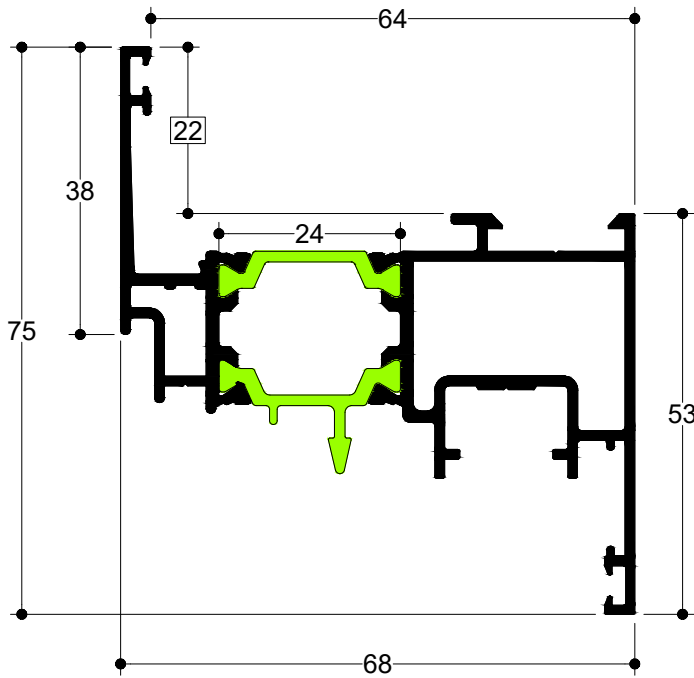

**TH 57232**

6,0 m | 1.308 gr/m  
Φύλλο Τζαμιού  
(Περμ. Μηχ.)  
Glass Sash  
(ALU 16 Groove)

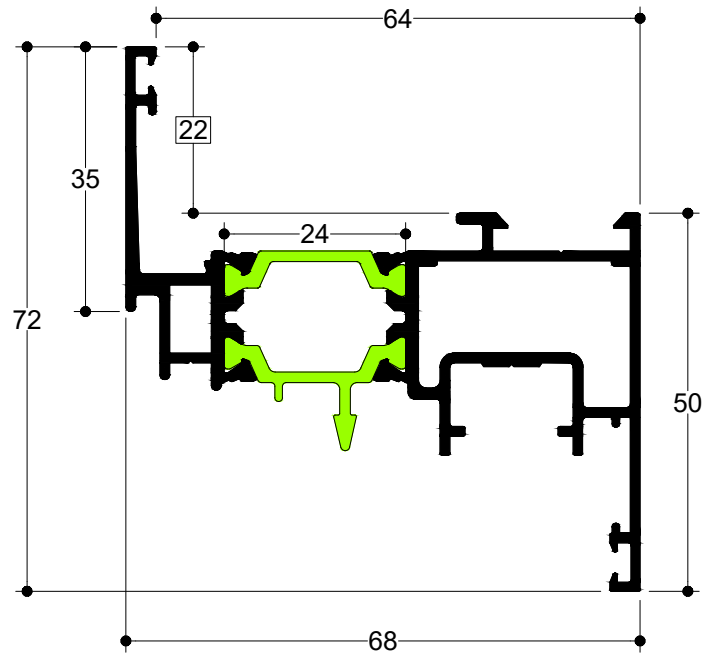

**TH 57233**

6,0 m | 1.361 gr/m  
Φύλλο Τζαμιού  
(Περμ. Μηχ.)  
Glass Sash  
(ALU 16 Groove)

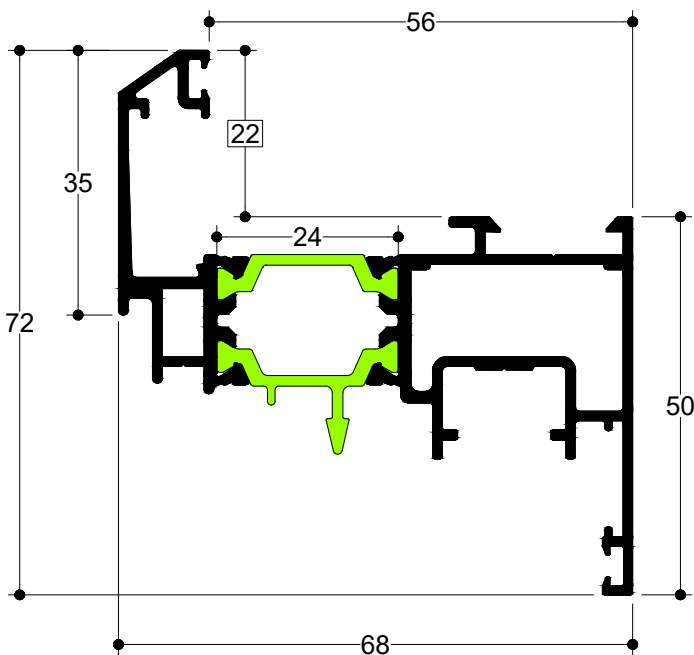

**TH 57331**

6,0 m | 1.359 gr/m  
Μπινί (Περμ. Μηχ.)  
Adjoining Profile  
(ALU 16 Groove)

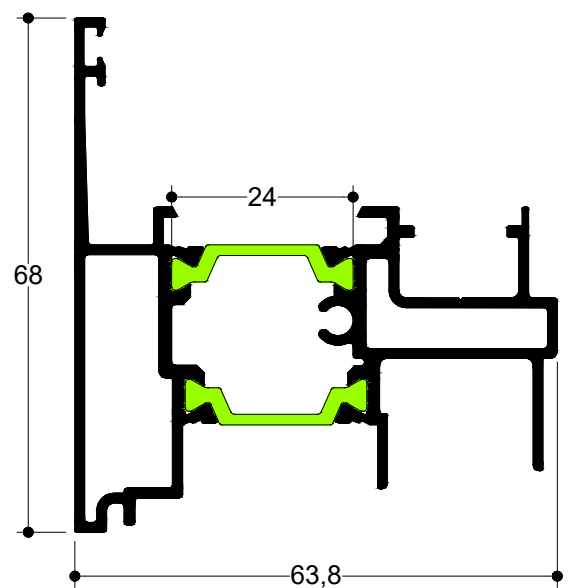

**TH 57206**

6,5 m 1.851 gr/m  
 Φύλλο Πόρτας  
 Door Sash

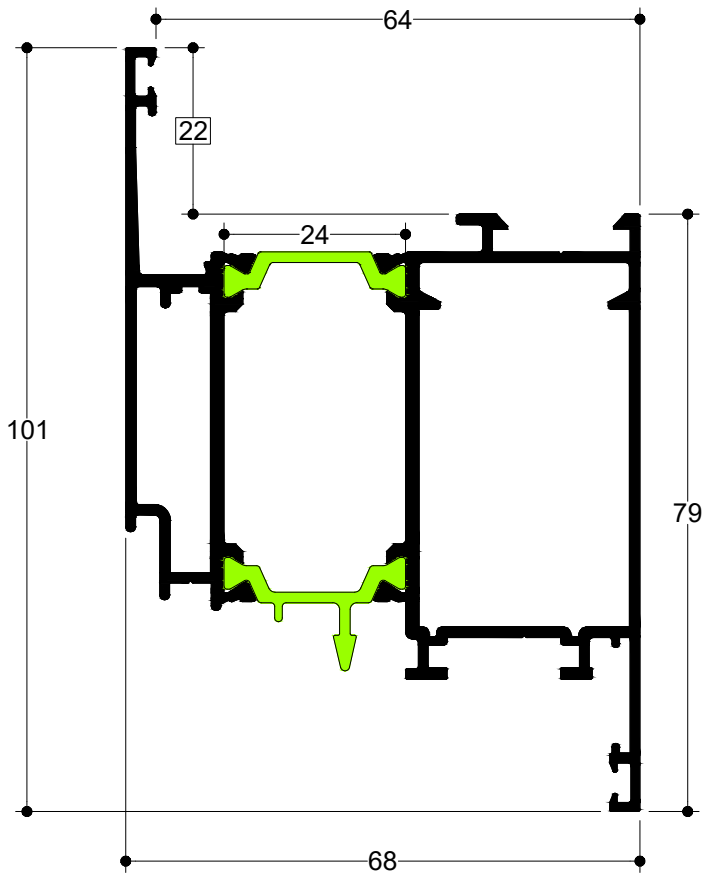

**TH 57213**

6,5 m 1.571 gr/m  
 Φύλλο Παραθύρου  
 Εξωτερικά Ανοιγόμενο  
 Outwards Opening  
 Window Sash

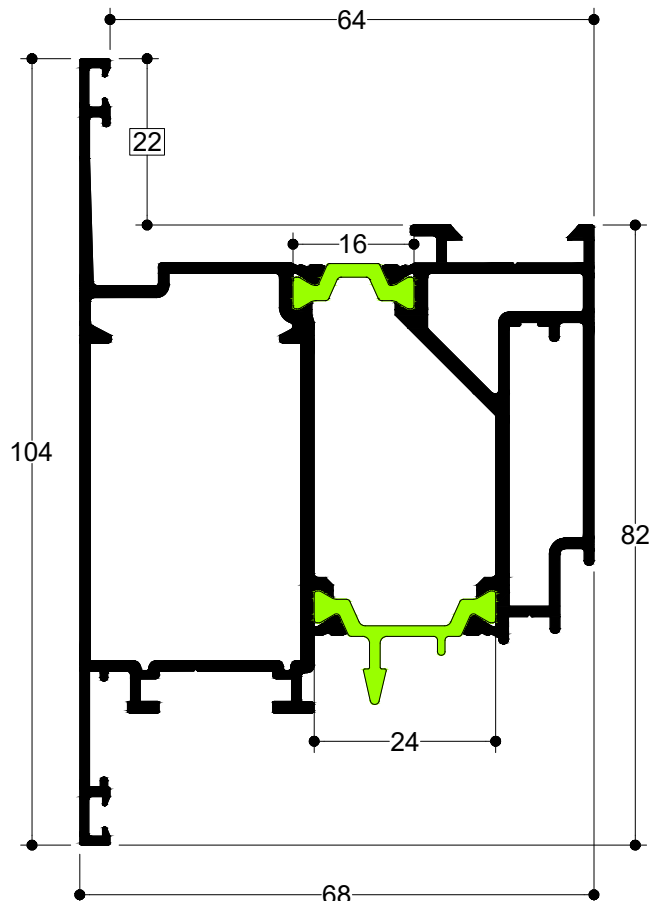
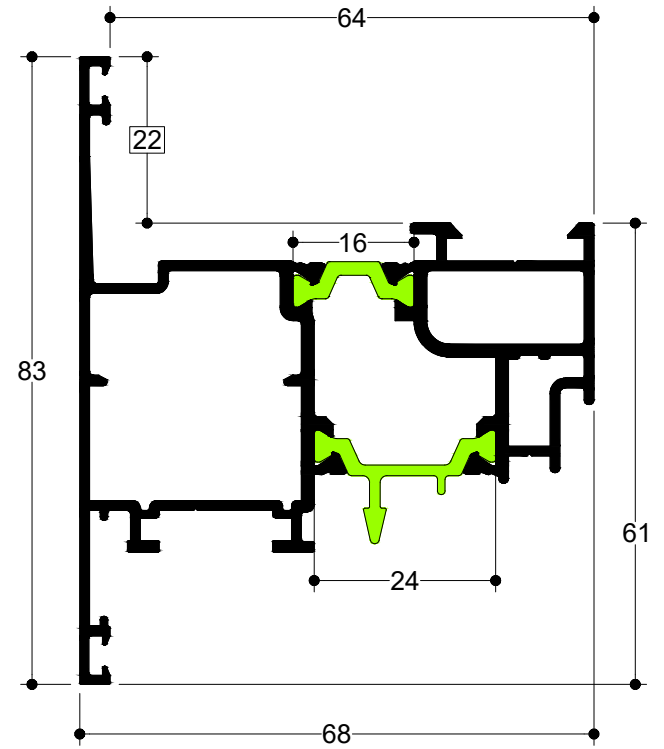

**TH 57208**

6,5 m 2.035 gr/m  
 Φύλλο Πόρτας  
 Εξωτερικά Ανοιγόμενο  
 Outwards Opening  
 Door Sash



**TH 57234**

6,5 m | 1.877 gr/m  
Φύλλο Πόρτας  
(Περμ. Μηχ.)  
Door Sash  
(ALU 16 Groove)

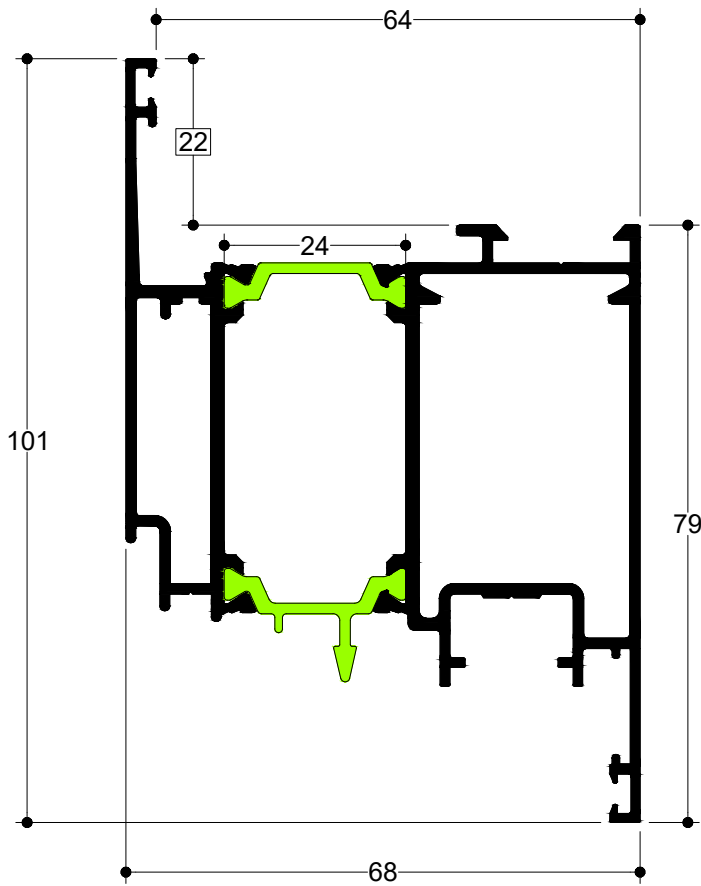

**TH 57235**

6,5 m | 2.045 gr/m  
Φύλλο Πόρτας Εξωτερικά  
Ανοιγόμενο (Περμ. Μηχ.)  
Outwards Opening  
Door Sash (ALU 16 Groove)

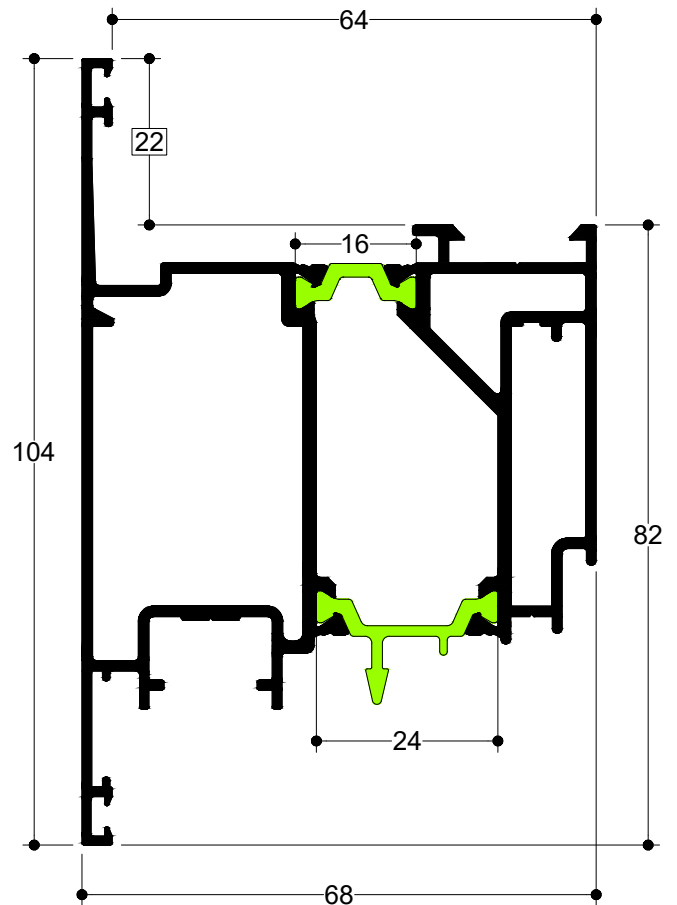

**TH 57402**

6,0 m | 1.262 gr/m

Χώρισμα φύλλου  
Transom for window sash

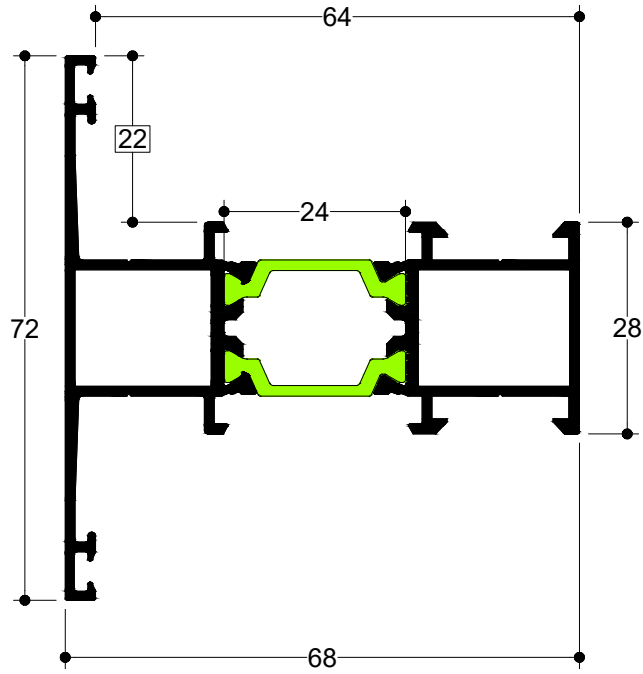

**TH 57405**

6,0 m | 1.579 gr/m

Χώρισμα κάσας -φύλλου  
Transom for frame-window sash

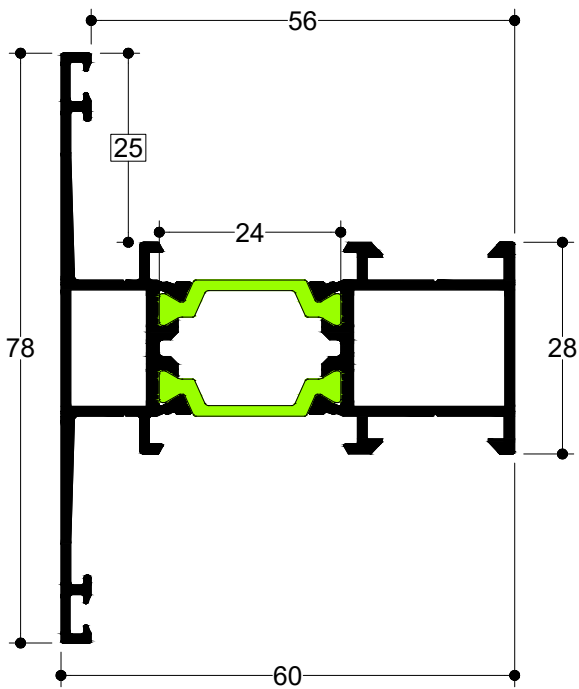

**TH 57406**

6,0 m | 1.672 gr/m

Χώρισμα κάσας -φύλλου  
Transom for frame-window sash

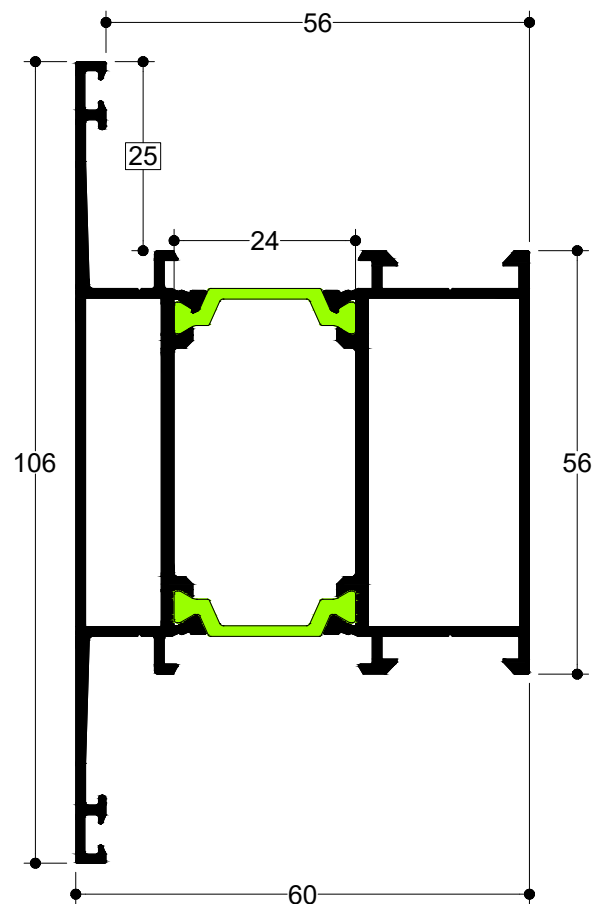

**TH 57409**

6,0 m 1.932 gr/m

Ταμπλάς  
Kickplate

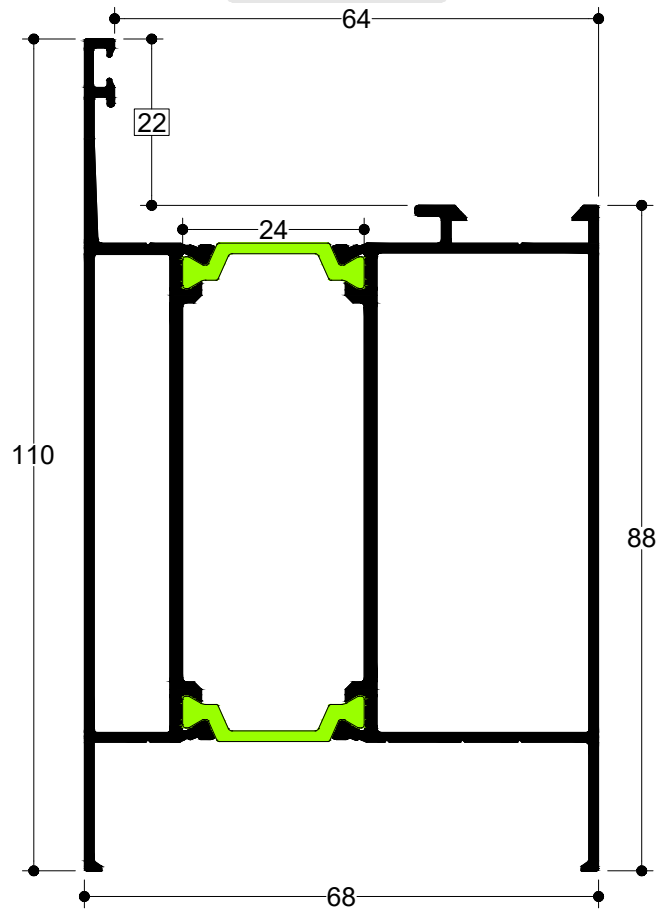

**TH 57107**

6,0 m 718 gr/m

Κατωκάσι  
Threshold

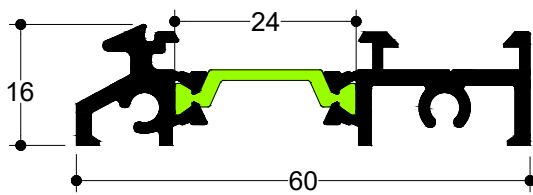

**TH 57110**

6,0 m 651 gr/m

Κατωκάσι  
Threshold

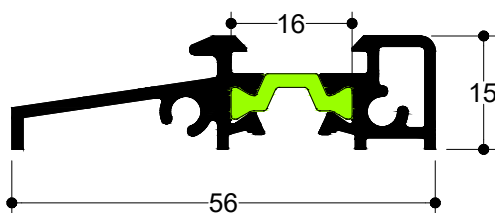

**TH 57623**

6,0 m 1.166 gr/m

Πρόσθετο Προφίλ  
Στεγάνωσης Πόρτας  
Door Sash Add-On  
Profile

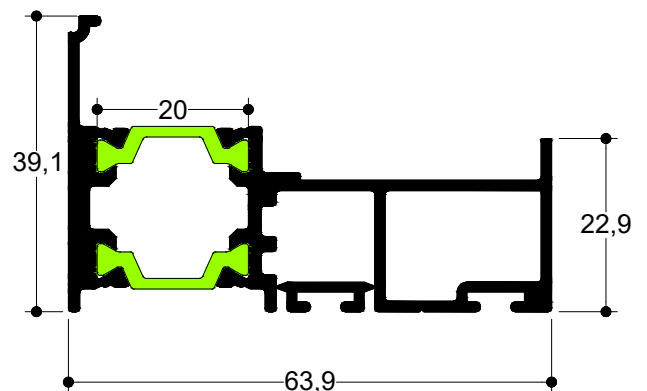

**TH 57105**

6,0 m 1.162 gr/m  
Κάσα Αλλαγής Φοράς  
Reversal Profile

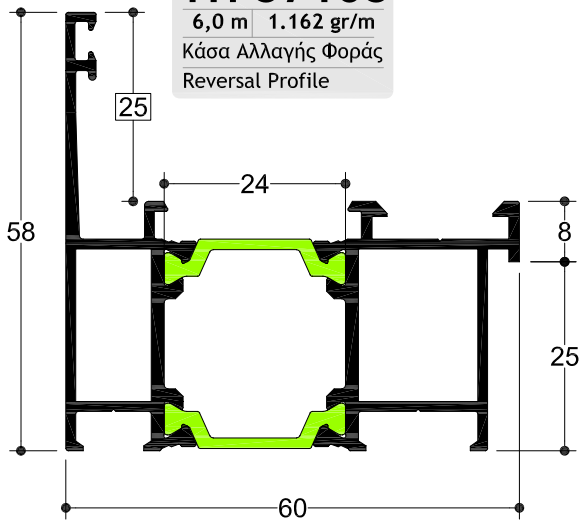

**TH 57604**

6,0 m 1.650 gr/m  
Γωνιακή Κολόνα  
Corner Mullion

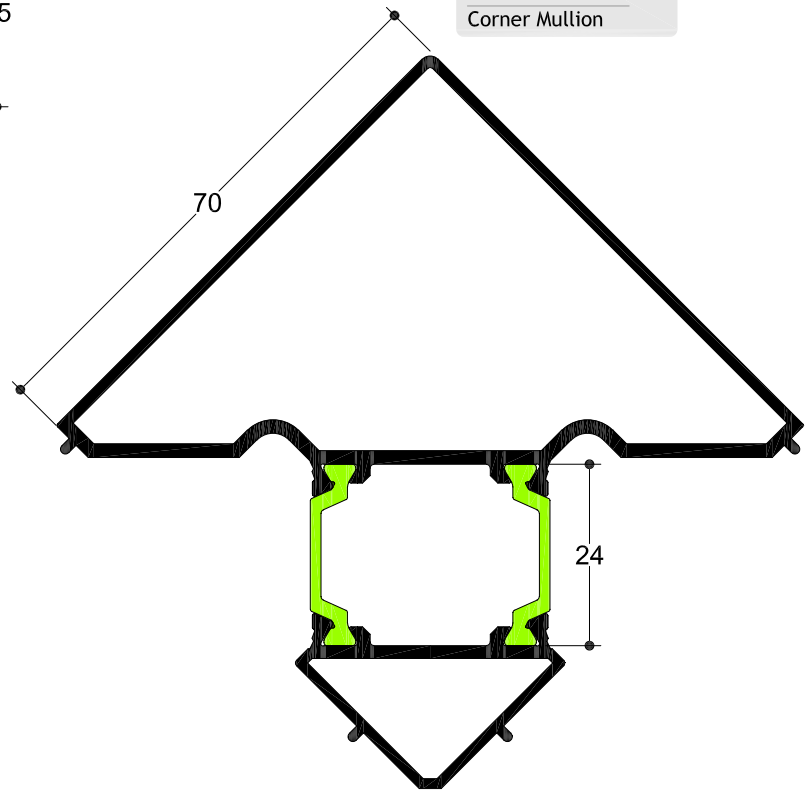

**TH 57603**

6,0 m 1.517 gr/m  
Συνδετικό Κασών  
Frame Connector

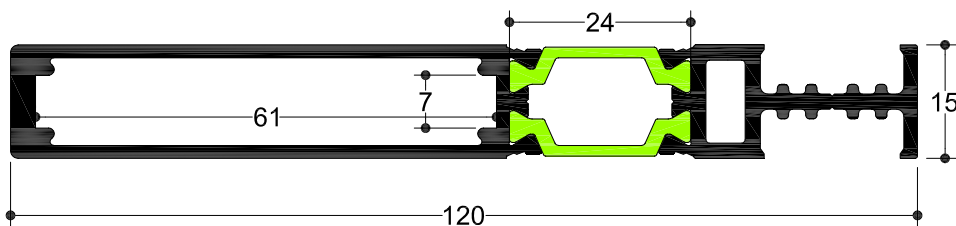

**TV 00626**

6,0 m 117 gr/m  
Συνδετικό Κασών  
Frame Connector

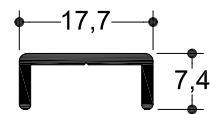

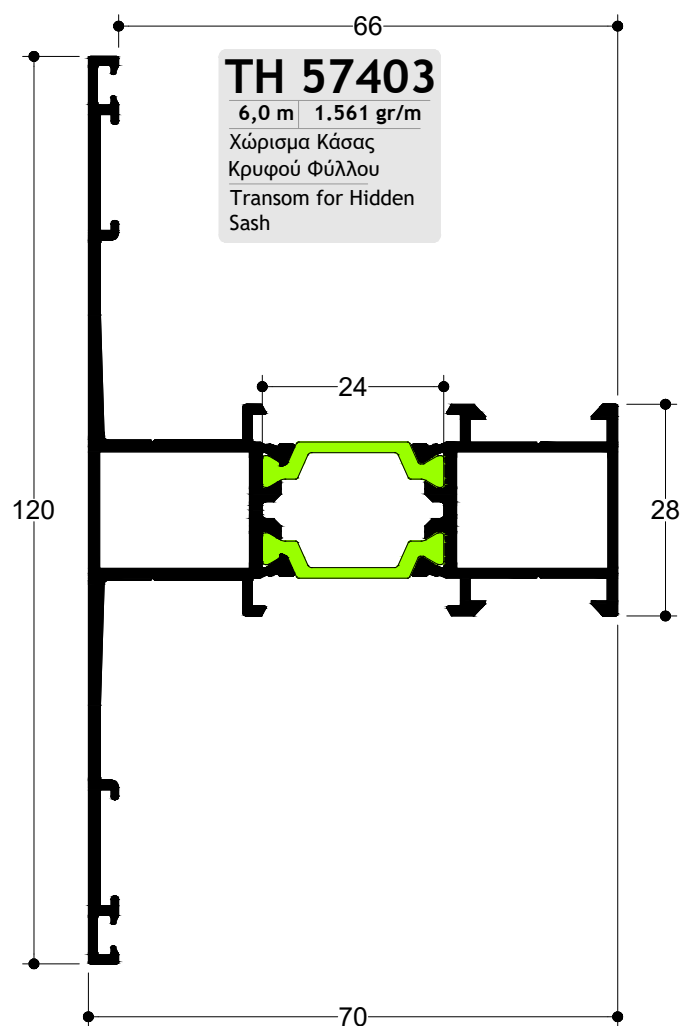
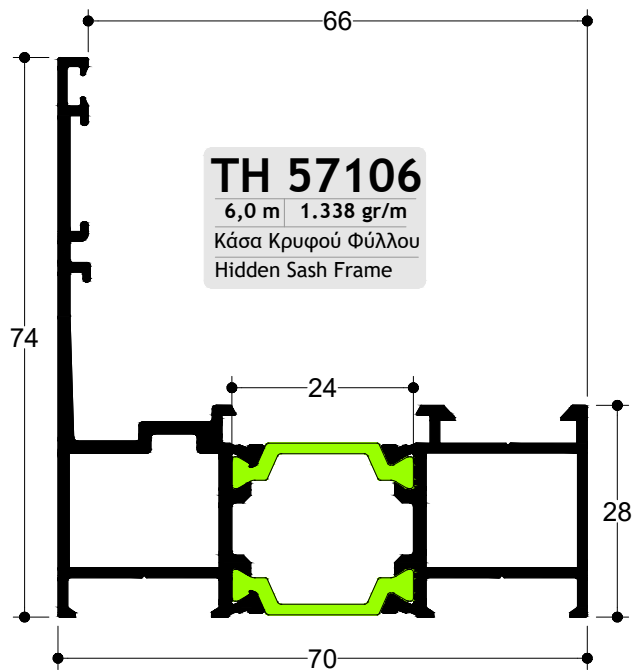

**TH 57210**

6,0 m | 1.263 gr/m  
Κρυφό Φύλλο  
Hidden Sash

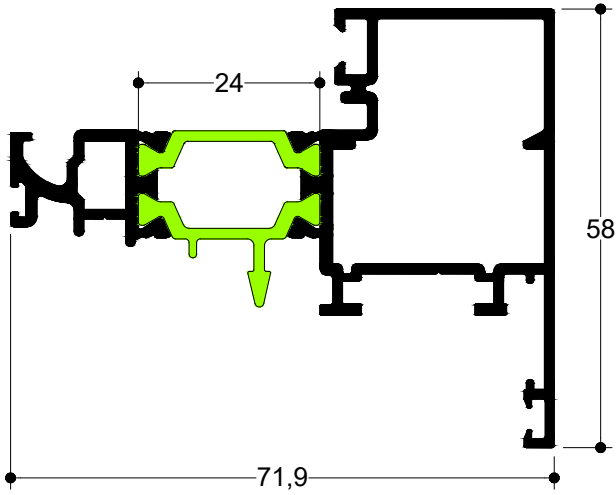

**TH 57211**

6,0 m | 1.280 gr/m  
Κρυφό Φύλλο  
(Περιμ. Μηχ.)  
Hidden Sash  
(ALU 16 Groove)

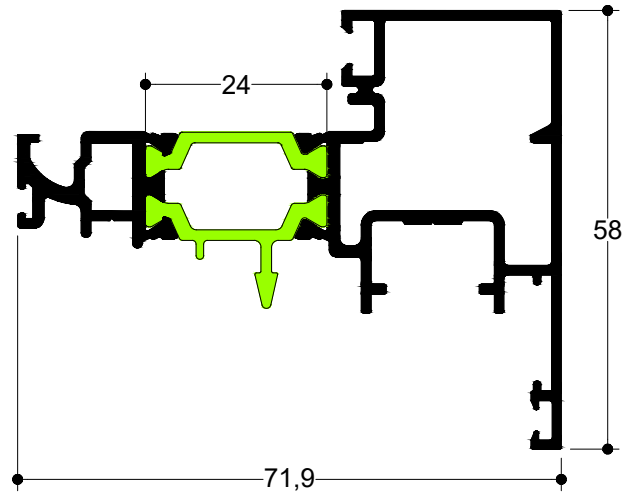

**TH 57302**

6,0 m | 1.723 gr/m  
Μπινί Κρυφού Φύλλου  
Adjoining Profile for  
Hidden Sash

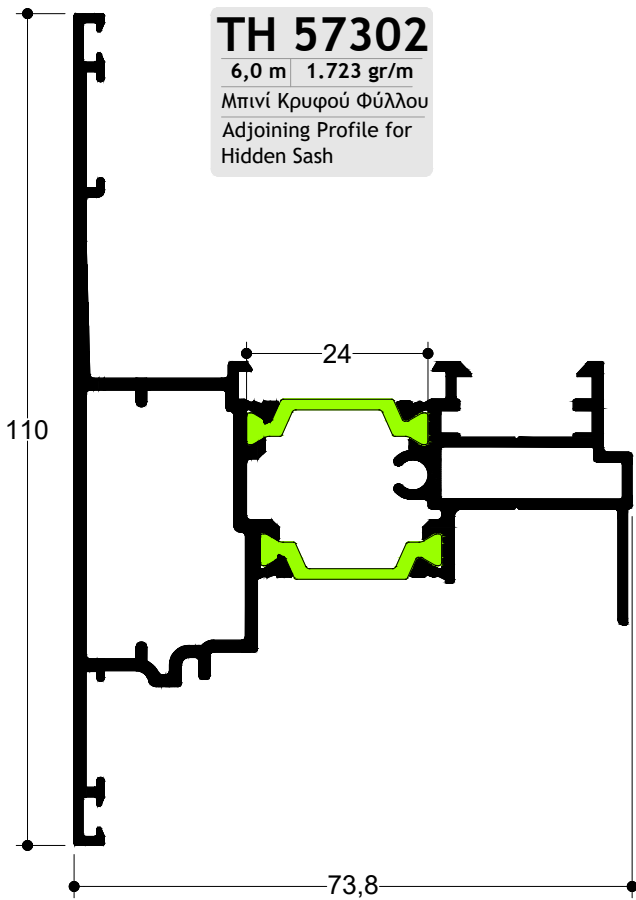

**TH 57332**

6,0 m | 1.758 gr/m  
Μπινί Κρυφού Φύλλου  
(Περιμ. Μηχ.)  
Adjoining Profile for  
Hidden Sash (ALU 16 Groove)

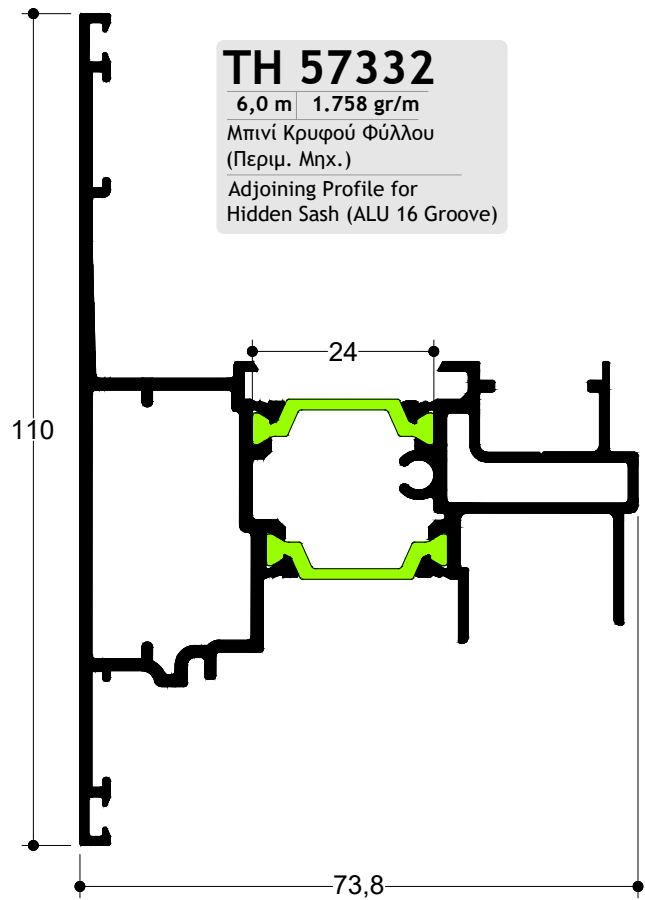

**TV 895**

6,0 m | 820 gr/m  
Φύλλο Πατζουριού  
Shutter Sash

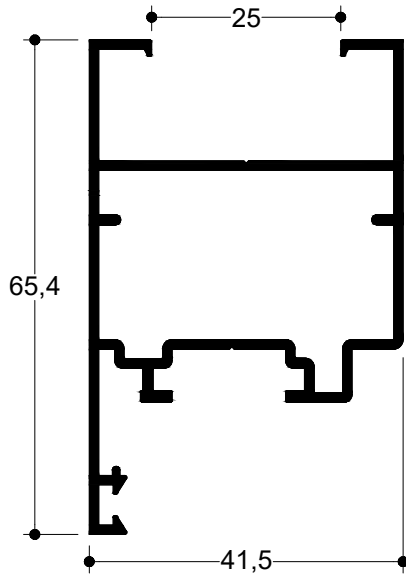

**TV 896**

6,0 m | 688 gr/m  
Μπινί Πατζουριού  
Adjoining Profile for  
Shutter

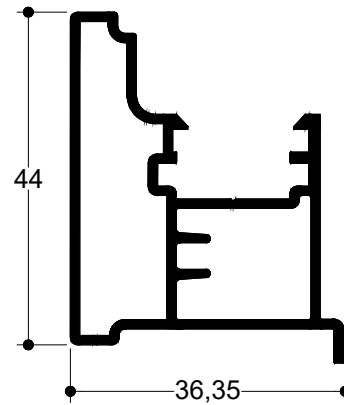

**TV 2266**

6,0 m | 777 gr/m  
Χώρισμα Πατζουριού  
Transom for  
Shutter Sash

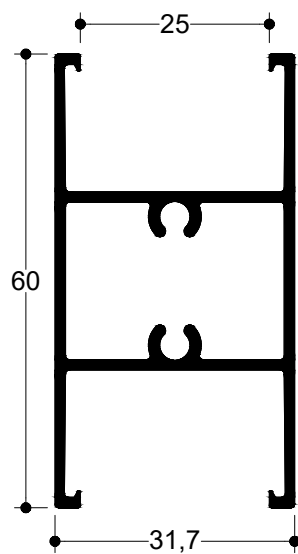

**TV 897**

6,0 m | 553 gr/m  
Κάσα Πατζουριού  
Frame for Shutter

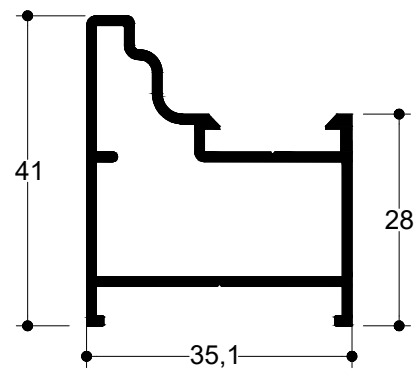

**TV 5050**

6,0 m | 150 gr/m  
Ντίζα κίνησης  
Mechanism rod

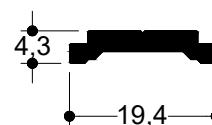

**TV 57601**

6,0 m | 170 gr/m

Νεροσταλλάκτης  
Φύλλου

Water Drip Profile for  
Sash

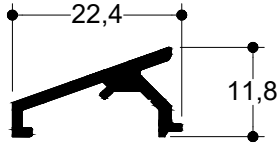

**TV 57605**

6,0 m | 298 gr/m

Προφίλ Στεγάνωσης  
Πόρτας

Water Insulation  
Profile for Door

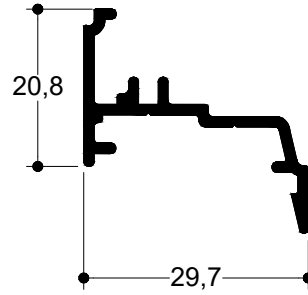

**TV 57625**

6,0 m | 235 gr/m

Πρόσθετο Προφίλ  
Στεγάνωσης Πόρτας  
Door Sash Add-On  
Profile

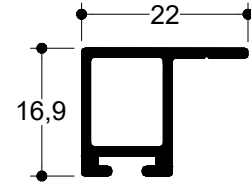

**TV 56521**

6,0 m | 344 gr/m

Προσθήκη Κάσας  
Κρυφού Φύλλου

Frame add-on for  
Hidden Sash

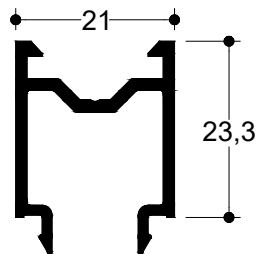

**TV 5040**

6,0 m | 119 gr/m

Αντάπτορας / Adapter  
TV 57502

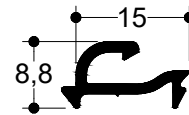

**TV 12603**

6,0 m | 1.368 gr/m

Κολόνα Ενίσχυσης

Reinforcement Mullion

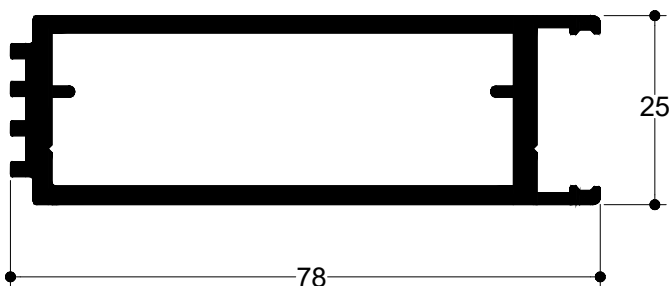

**TV 12503**

6,0 m | 119 gr/m

Καπάκι Κολόνας

Ενίσχυσης

Cover for  
Reinforcement Mullion

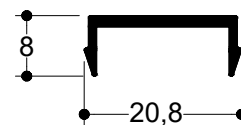



**PER 233**

6,0 m | 525 gr/m  
Φυλλαράκι κινητής περσίδας  
Profile for movable louver

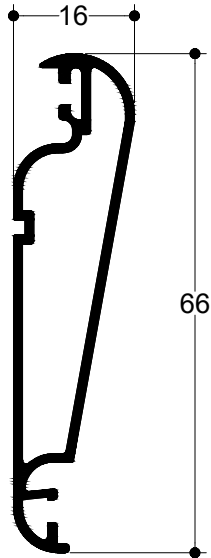

**PER 232**

6,0 m | 381 gr/m  
Ρυθμιστής Κινητής Περσίδας  
Regulator of Movable Louver

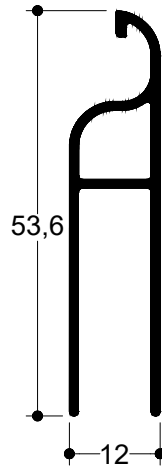

**PER 231**

6,0 m | 317 gr/m  
Προσθήκη Τελειώματος  
Κινητής Περσίδας  
Additional Ending Profile  
for Movable Louver

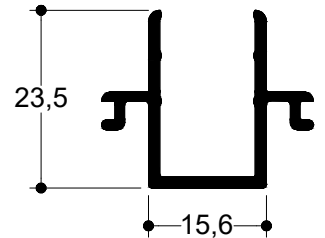

**TV 57627**

6,0 m | 336 gr/m  
Αρμολάκι  
Gap cover

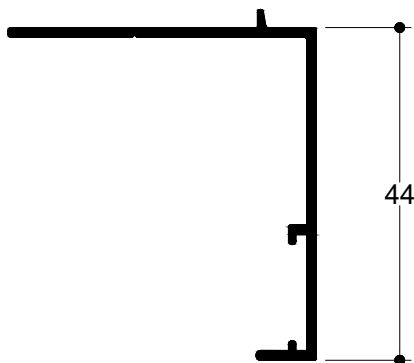

**TV 57602**

6,0 m | 230 gr/m  
Τακάκι Στήριξης  
Υαλοπίνακα  
Spacer Wedge for  
Glass

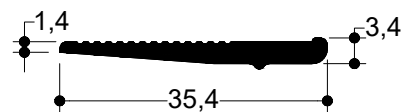

**P3**

5,0 m | 368 gr/m  
ΟΒαλίνα  
Fixed Louver Profile

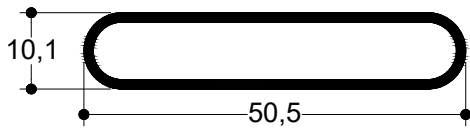

**TV 2080**

6,0 m | 253 gr/m  
Πηχάκι οβαλίνας  
Clip for P3 louver

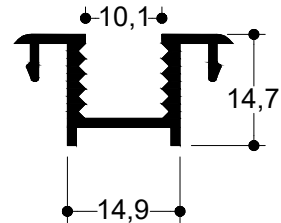

**TV 5066**

6,0 m | 421 gr/m  
ΟΒαλίνα Ασφαλείας  
Security Fixed Louver

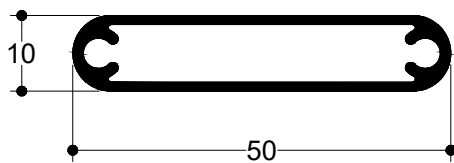

**TV 5067**

6,0 m | 220 gr/m  
Τελείωμα ΟΒαλίνας Ασφαλείας  
Additional Ending Profile for Security Fixed Louver

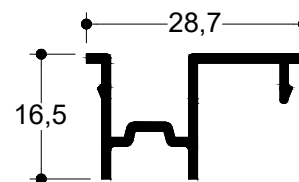

**PER 270**

6,0 m | 441 gr/m  
Φυλλαράκι Πατζουριού (Τουλίπα)  
Fixed Louver Profile  
7.1 Kgr/m<sup>2</sup> | 16 τεμ./m

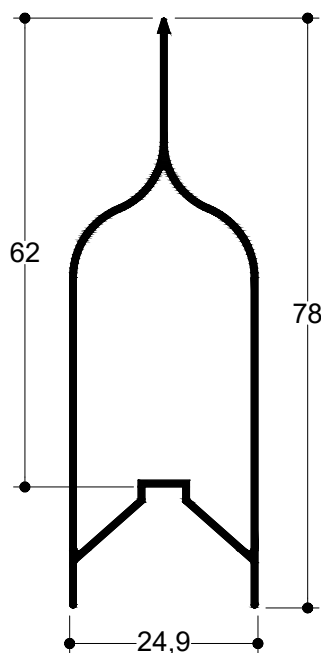

**PER 320**

6,0 m | 408 gr/m  
Φυλλαράκι Πατζουριού  
Fixed Louver Profile  
6.15 Kgr/m<sup>2</sup> | 15 τεμ./m

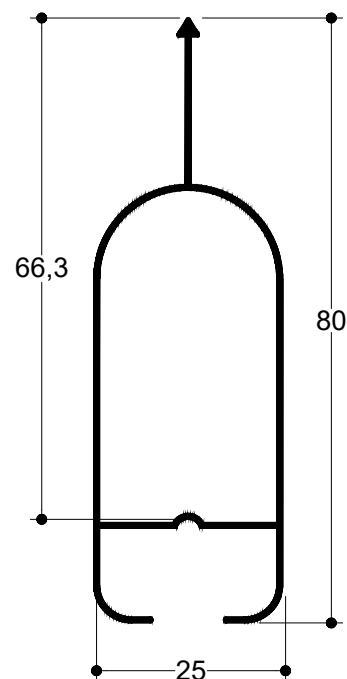

**PER 250**

6,0 m | 547 gr/m  
Φυλλαράκι Πατζουριού (Κρινάκι)  
Fixed Louver Profile  
7.6 Kgr/m<sup>2</sup> | 14 τεμ./m

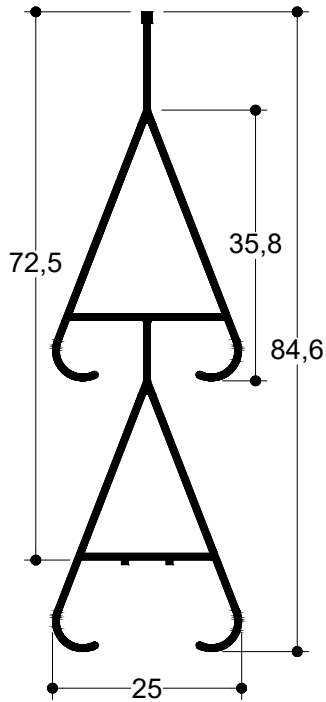

**PER 260**

6,0 m | 620 gr/m  
Φυλλαράκι Πατζουριού (Κρινάκι)  
Fixed Louver Profile  
6.8 Kgr/m<sup>2</sup> | 11 τεμ./m

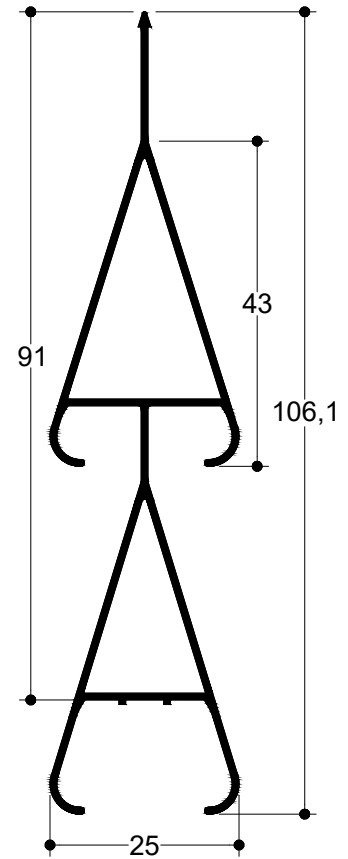

**PER 300**

6,0 m | 730 gr/m  
Φυλλαράκι Πατζουριού  
Fixed Louver Profile  
7.3 Kgr/m<sup>2</sup> | 10 τεμ./m

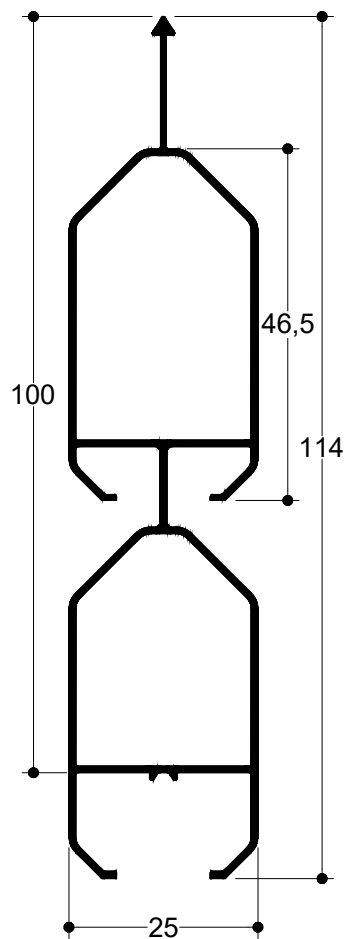

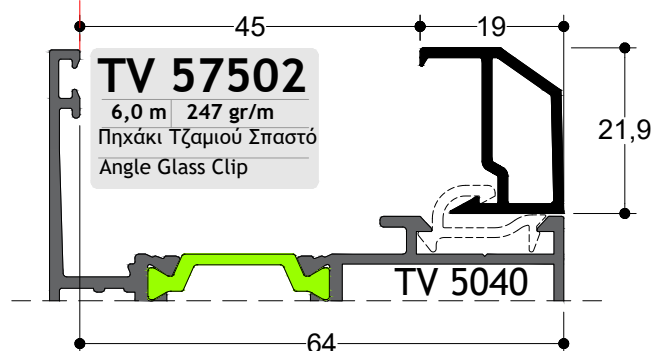
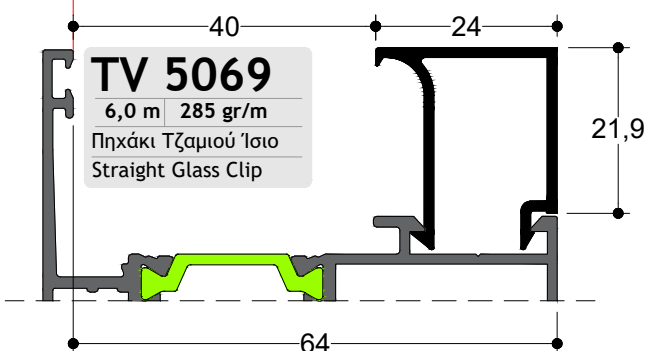
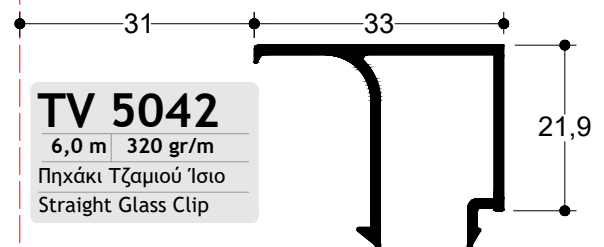
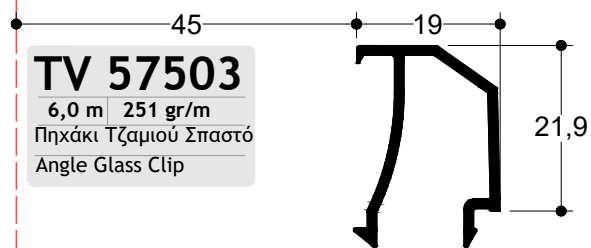
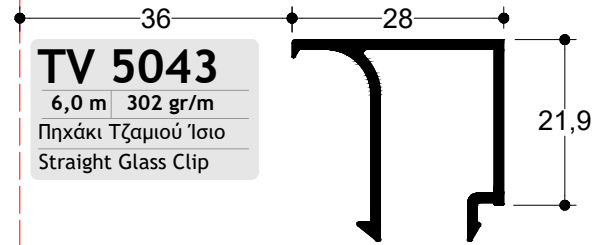
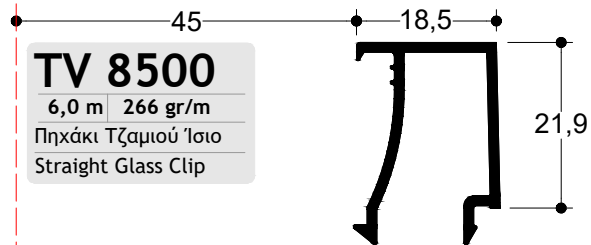
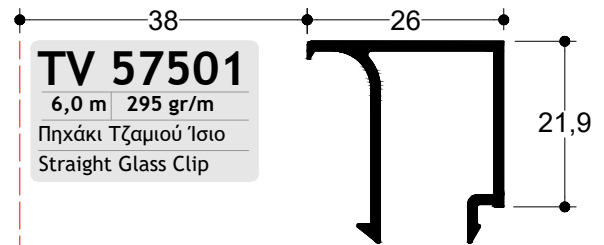
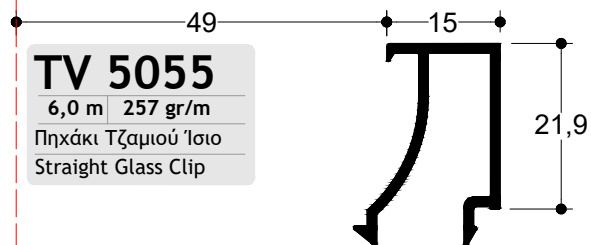
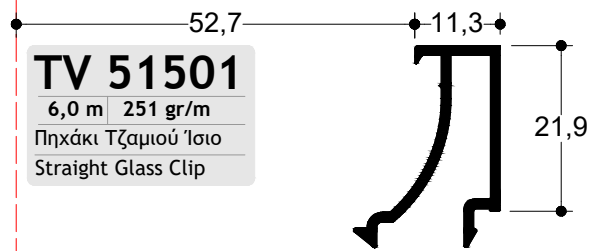
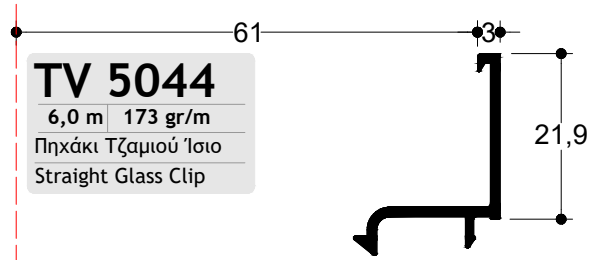

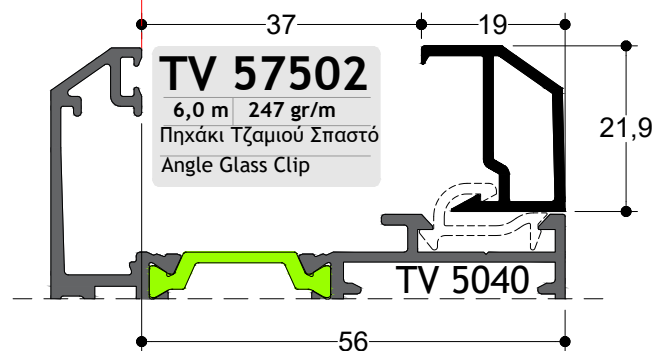
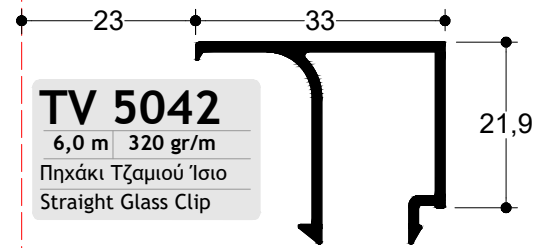
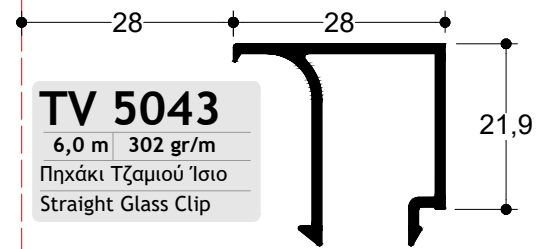
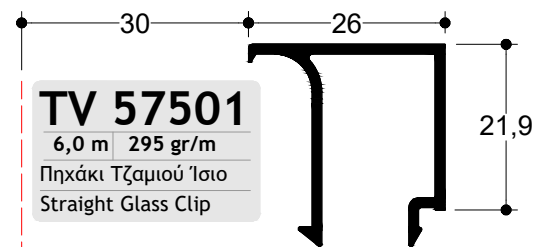
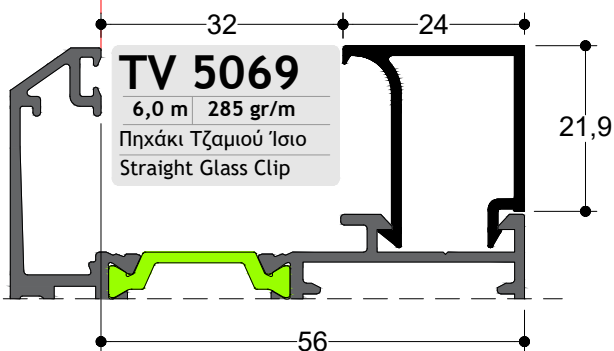
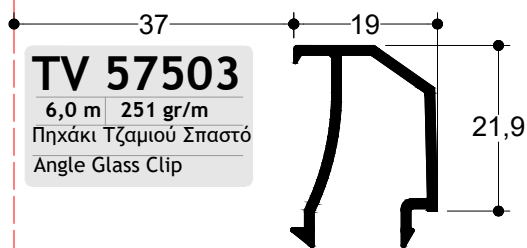
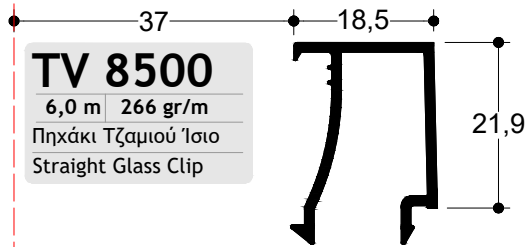
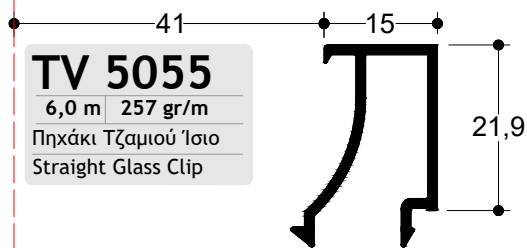
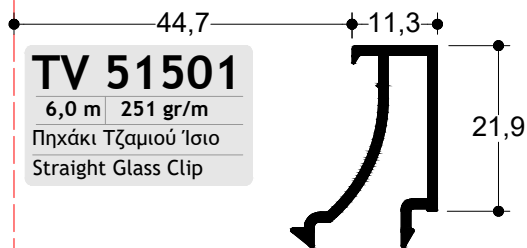
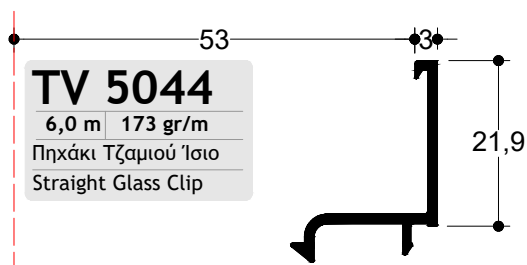



## 1.2 Τομές Sections

---





**1.2**

Κατασκευαστικές Τομές  
Sections

**ΜΟΝΟΦΥΛΛΟ (Α/Α)**  
SINGLE SASH (T/T)

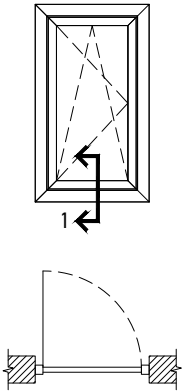

**ΔΙΦΥΛΛΟ (Α/Α)**  
DOUBLE SASH (T/T)

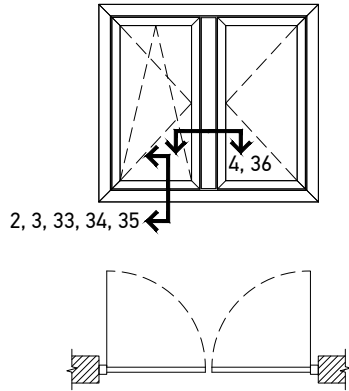

**ΜΟΝΟΦΥΛΛΟ Α/Α ΜΕ ΣΤΑΘΕΡΟ**  
SINGLE SASH T/T WITH FIXED

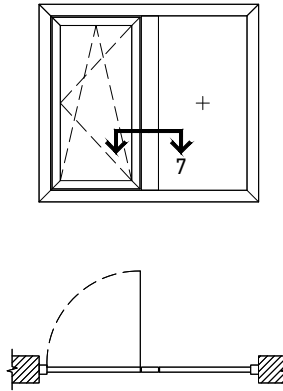

**ΜΟΝΟΦΥΛΛΟ ΕΞΩΤΕΡΙΚΑ**  
**ΑΝΟΙΓΟΜΕΝΟ**  
SINGLE SASH OUTWARD OPENING

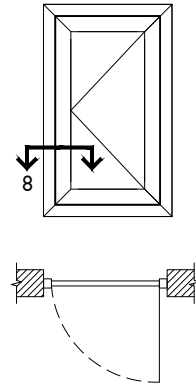

**ΜΟΝΟΦΥΛΛΟ ΣΤΑΘΕΡΟ**  
SINGLE FIXED

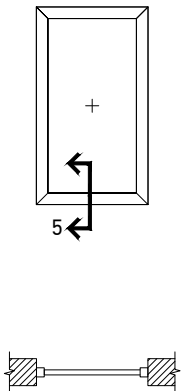

**ΜΟΝΟΦΥΛΛΑ Α/Α ΜΕ ΧΩΡΙΣΜΑ**  
SINGLE SASHES T/T & TRANSOM

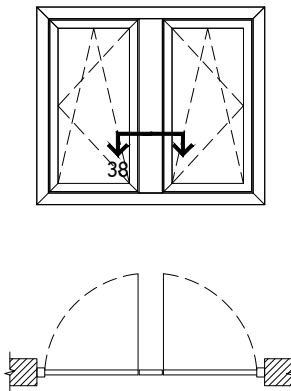

**ΔΙΦΥΛΛΟ Α/Α ΜΕ ΚΡΥΦΟ ΦΥΛΛΟ**  
DOUBLE HIDDEN SASH T/T

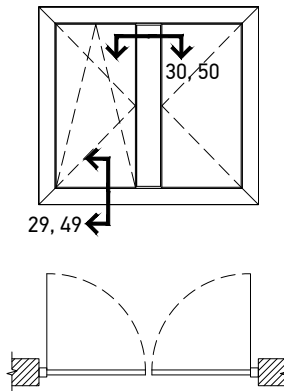

**ΜΟΝΟΦΥΛΛΑ Α/Α ΜΕ ΚΡΥΦΟ**  
**ΦΥΛΛΟ & ΧΩΡΙΣΜΑ**  
SINGLE HIDDEN SASH T/T & TRANSOM

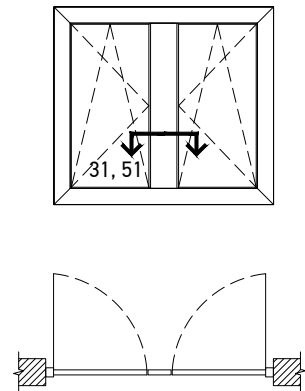

**ΜΟΝΟΦΥΛΛΟ Α/Α ΜΕ ΚΡΥΦΟ**  
**ΦΥΛΛΟ & ΣΤΑΘΕΡΟ**  
SINGLE HIDDEN SASH T/T & FIX

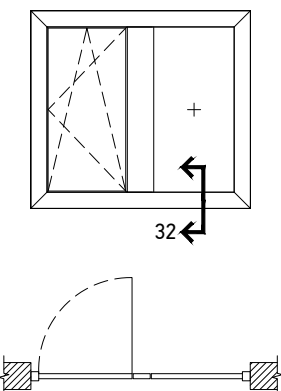

**ΔΙΦΥΛΛΟ Α/Α ΜΕ ΠΑΤΖΟΥΡΙ**  
DOUBLE SASH T/T WITH SHUTTER SASH

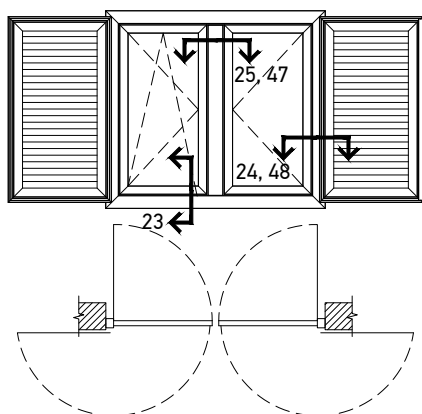

**ΔΙΦΥΛΛΟ Α/Α ΜΕ ΡΟΛΟ & ΣΗΤΑ**  
DOUBLE SASH T/T WITH ROLLER SHUTTER  
& INSECT SCREEN

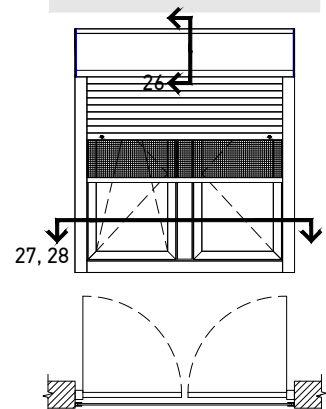

(Α/Α) = ΑΝΟΙΓΟΑΝΑΚΛΙΝΟΜΕΝΟ  
(T/T) = TILT AND TURN

**ΔΙΦΥΛΛΗ (Α/Α) ΜΠΑΛΚΟΝΟΠΟΡΤΑ ΜΕ ΧΑΜΗΛΟ ΚΑΤΩΚΑΣΙ**  
DOUBLE PATIO DOOR (T/T) WITH LOW THRESHOLD

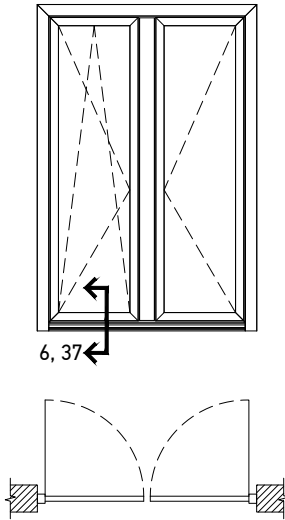

**ΜΟΝΟΦΥΛΛΗ ΠΟΡΤΑ**  
SINGLE DOOR

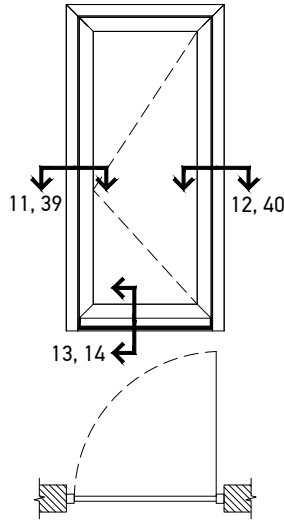

**ΜΟΝΟΦΥΛΛΗ ΠΟΡΤΑ ΜΕ ΤΑΜΠΛΑ**  
SINGLE DOOR WITH KICKPLATE

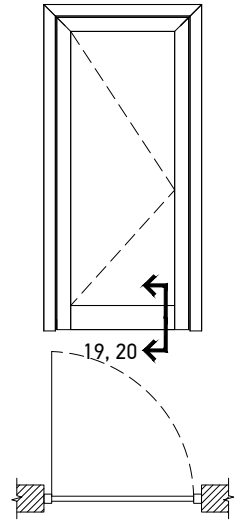

**ΜΟΝΟΦΥΛΛΗ ΠΟΡΤΑ ΜΕ ΣΤΑΘΕΡΟ**  
SINGLE DOOR WITH FIXED

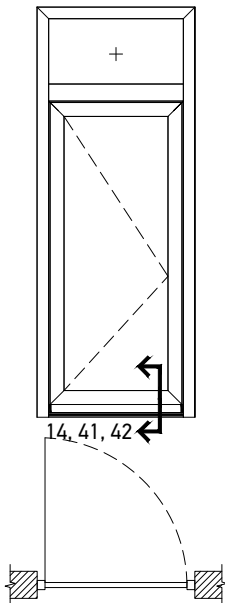

**ΜΟΝΟΦΥΛΛΗ ΠΟΡΤΑ ΜΕ ΣΤΑΘΕΡΟ**  
SINGLE DOOR WITH FIXED

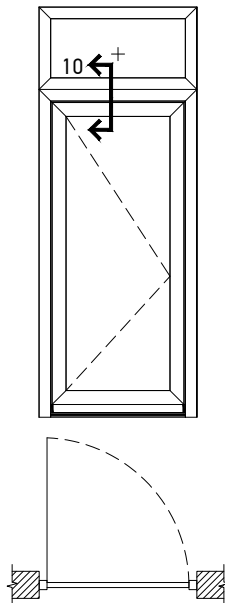

**ΜΟΝΟΦΥΛΛΗ ΠΟΡΤΑ ΕΞΩΤΕΡΙΚΑ ΑΝΟΙΓΟΜΕΝΗ**  
OUTWARDS OPENING SINGLE DOOR

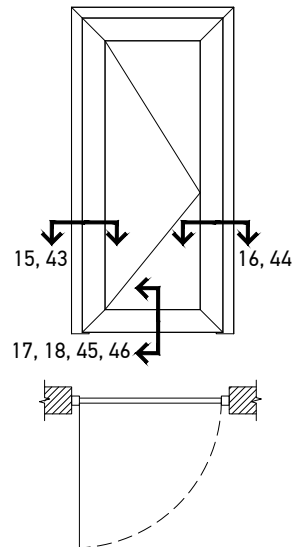

**ΜΟΝΟΦΥΛΛΗ ΠΟΡΤΑ ΕΞΩΤΕΡΙΚΑ ΑΝΟΙΓΟΜΕΝΗ ΜΕ ΣΤΑΘΕΡΟ**  
OUTWARDS OPENING SINGLE DOOR WITH FIXED

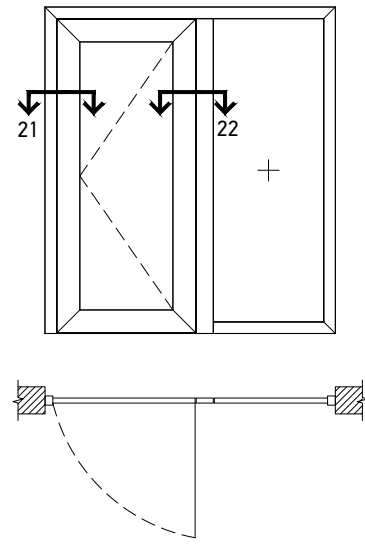

**ΔΙΦΥΛΛΟ ΕΠΑΛΛΗΛΟ ΜΕ ΦΕΓΓΙΤΗ**  
DOUBLE SUCCESSIVE WITH WINDOW

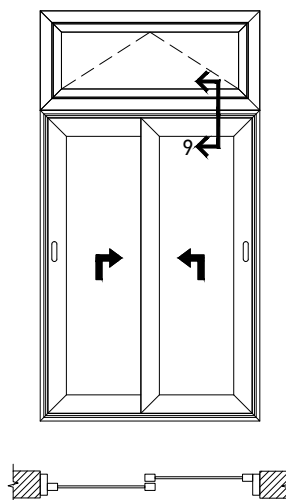

**ΓΩΝΙΑΚΗ ΚΑΤΑΣΚΕΥΗ ΜΕ ΣΤΑΘΕΡΟ**  
CORNER JOINT FIXED

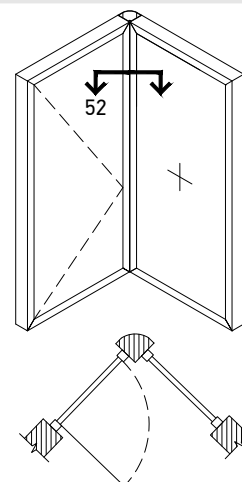

**TOMH SECTION 1**      **ΚΛΙΜΑΚΑ SCALE 1:1**

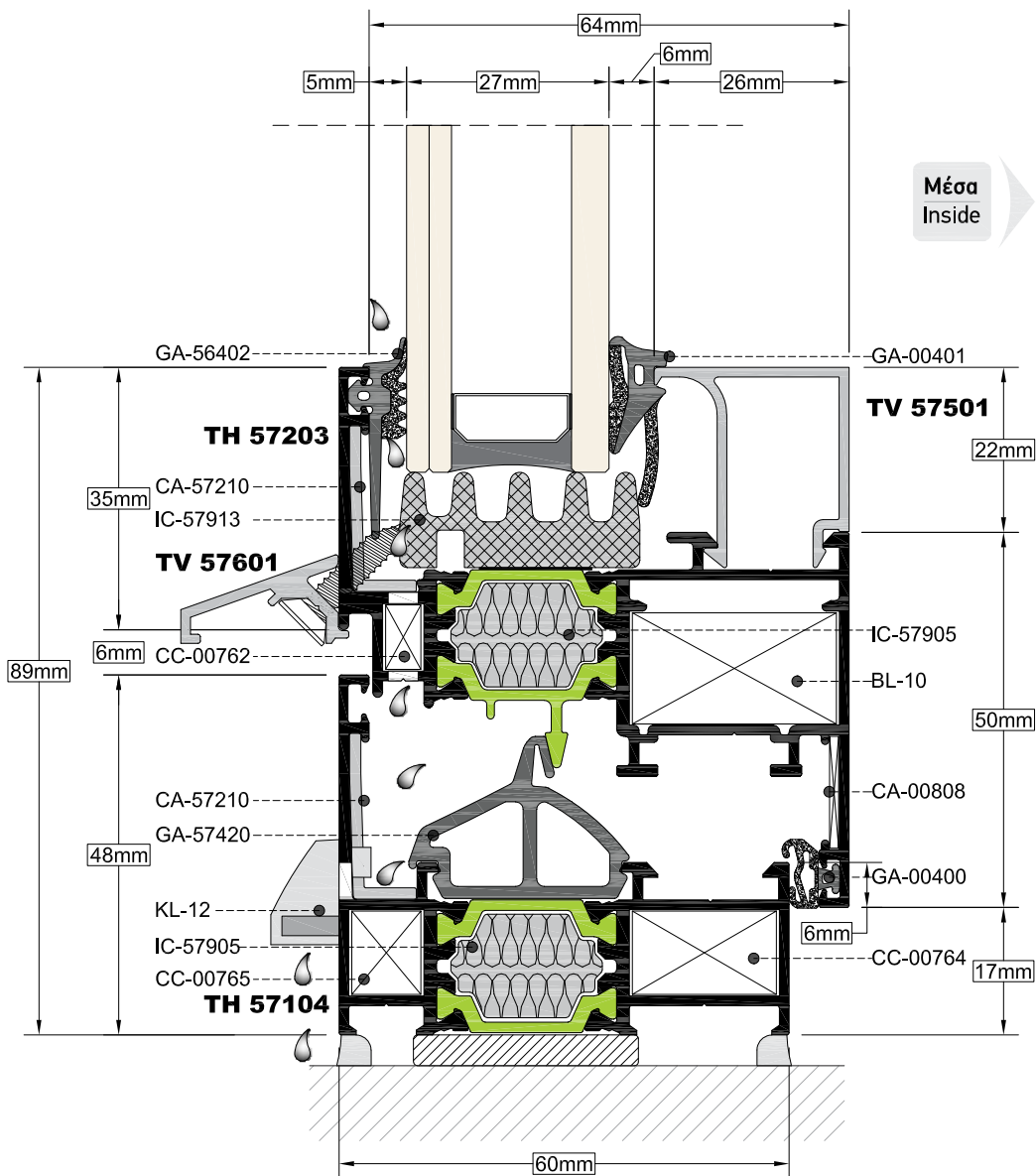
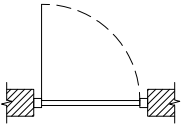
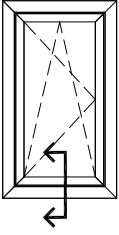

**ΤΟΜΗ 2**  
SECTION

**ΚΑΙΜΑΚΑ 1:1**  
SCALE

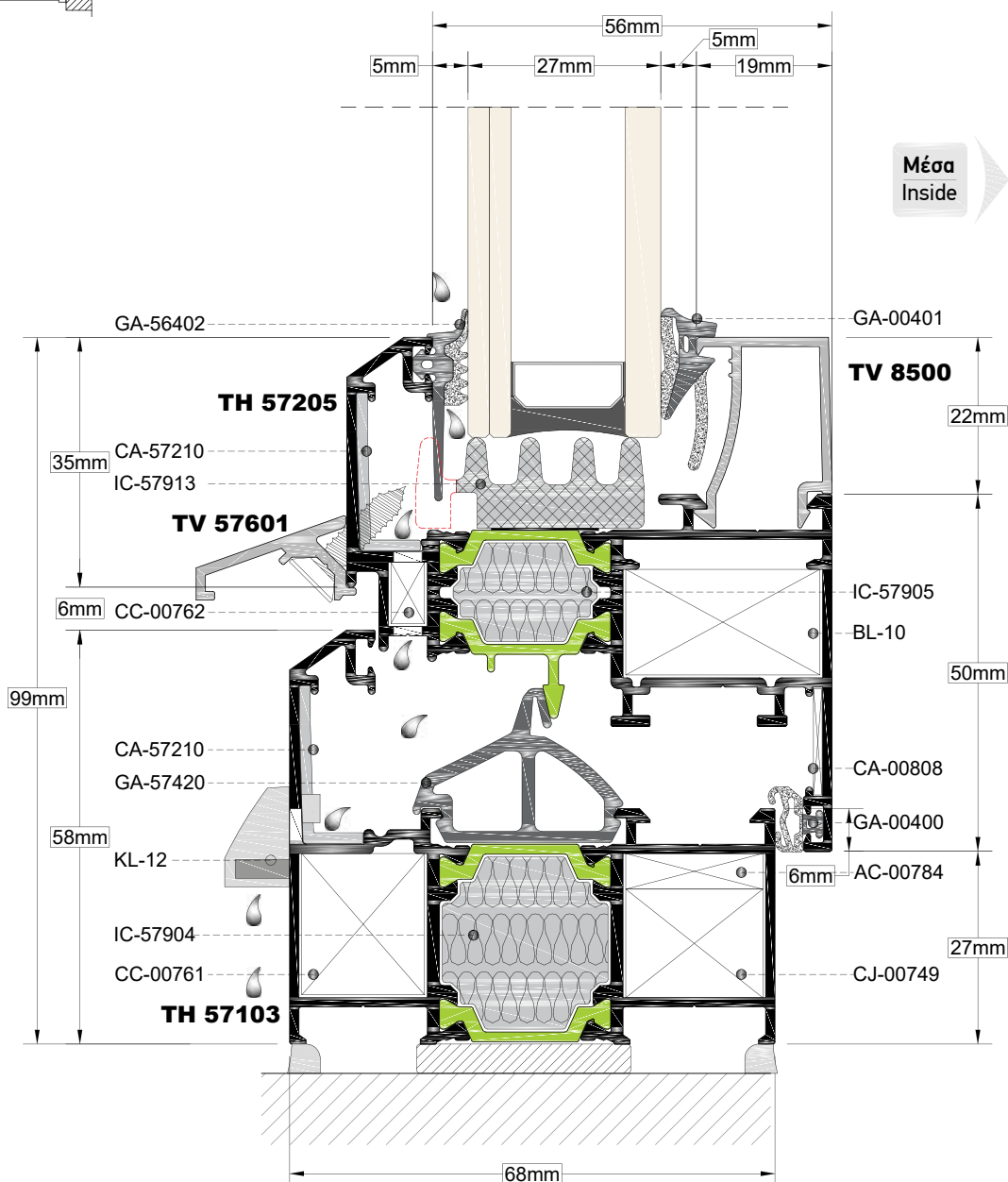
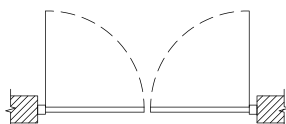
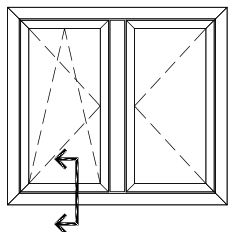

Σε κατασκευές με σταθερό, μετά την τοποθέτηση του μονωτικού υλικού με μια φαλτσέτα αφαιρούμε την μαρκαρασμένη περιοχή στα σημεία των νεροχυτών.

For any fixed construction after the installation of insulation foam we remove the marked area with the use of retractable knife near to weep holes.

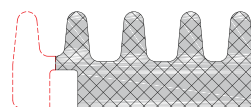

\*Ακολουθούμε την ίδια διαδικασία και για τα φύλλα TH-57205 & TH-57233

\*Follow the same process of removing for the profile sashes TH-57205 & TH-57233

**TOMH SECTION 3**      **ΚΑΙΜΑΚΑ SCALE 1:1**

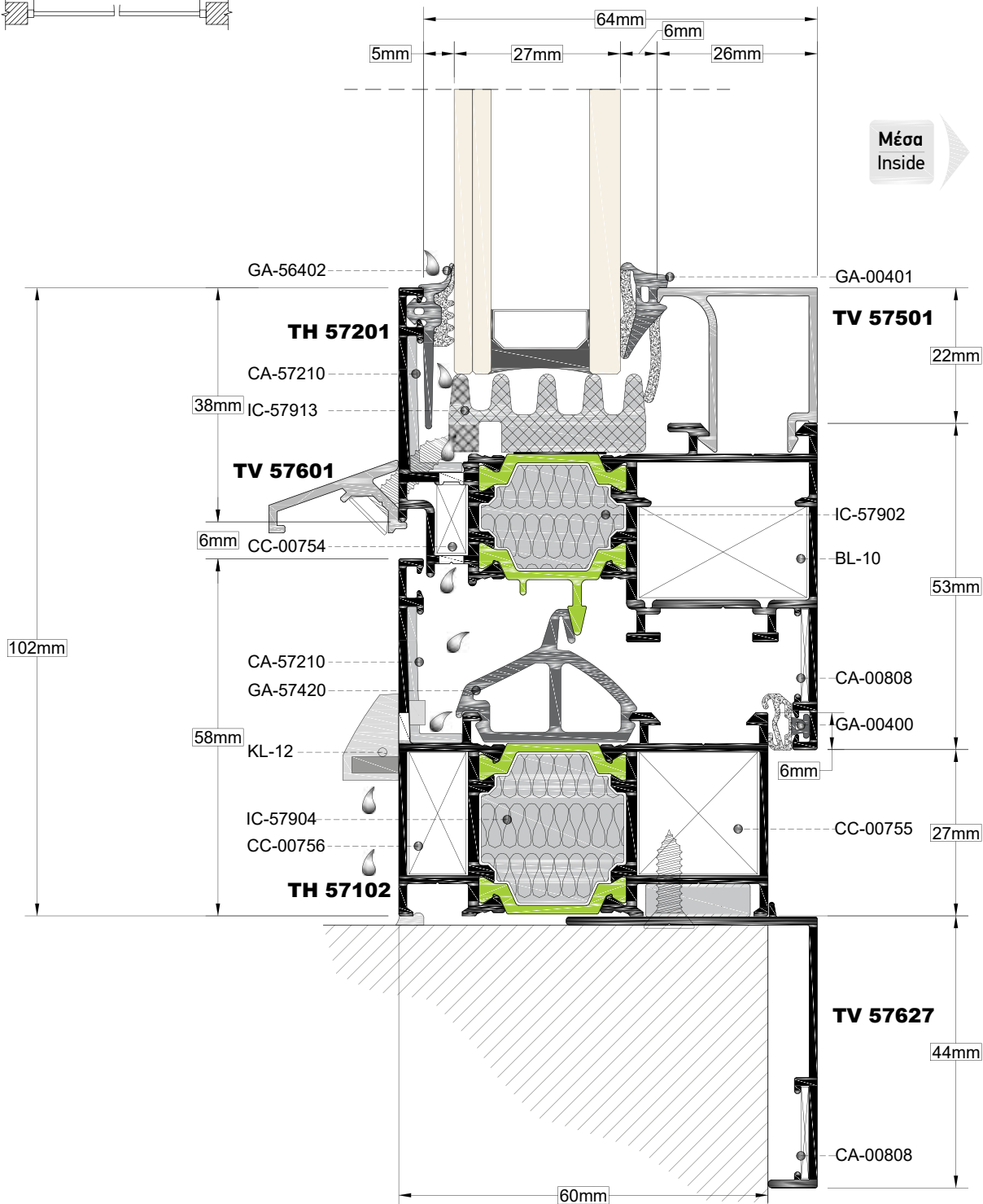
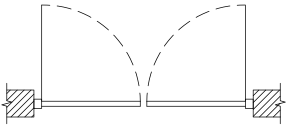
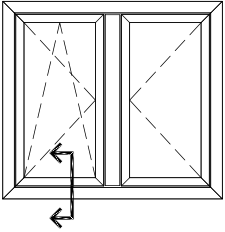

**TOMH**  
SECTION **4**

**ΚΑΙΜΑΚΑ**  
SCALE **1:1**

**Uf : 2,80 W/m<sup>2</sup> K**

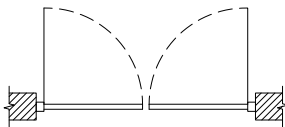
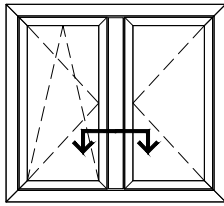

**Μέσα**  
Inside

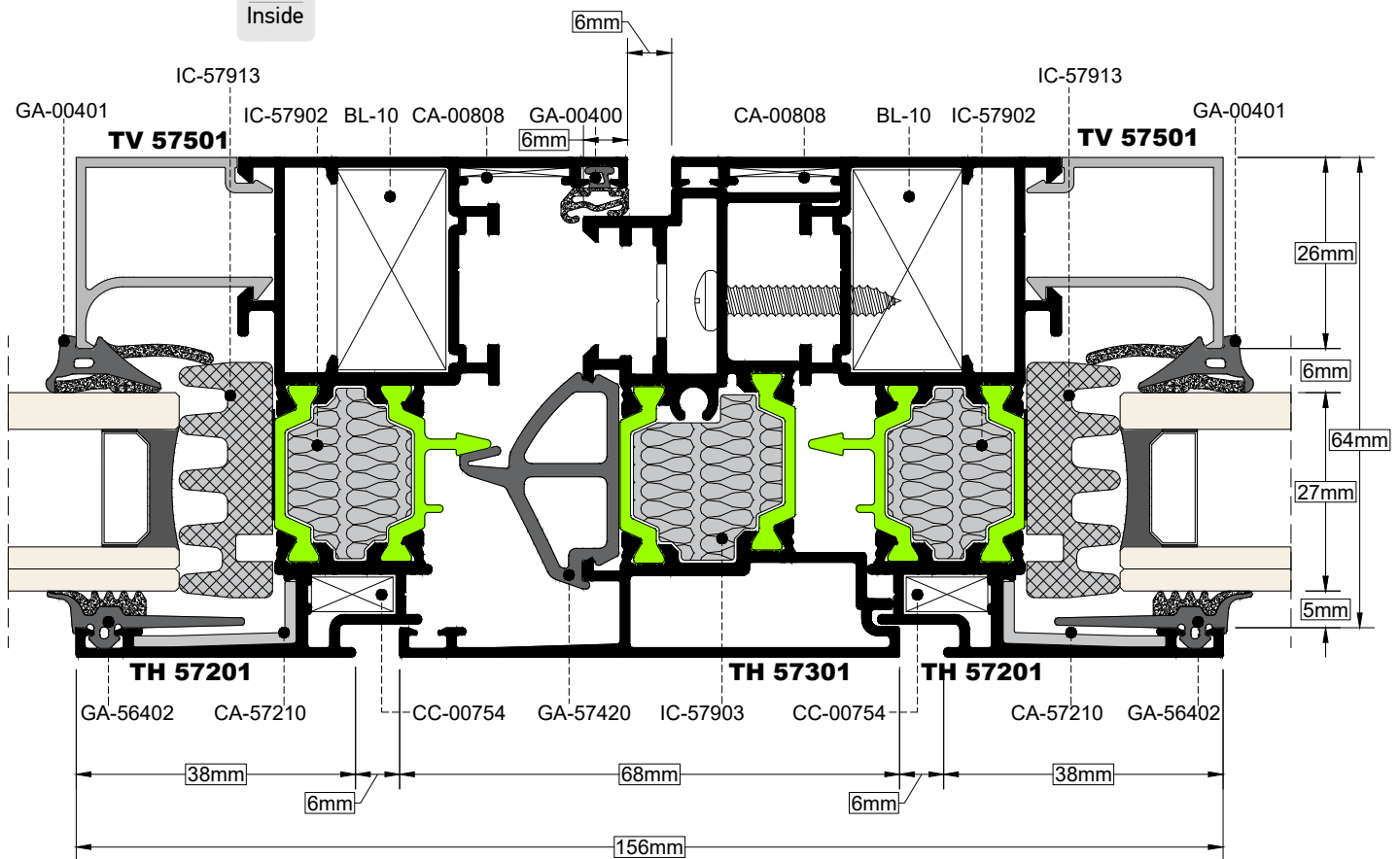

**TOMH** 5 **ΚΑΙΜΑΚΑ** 1:1  
SECTION SCALE

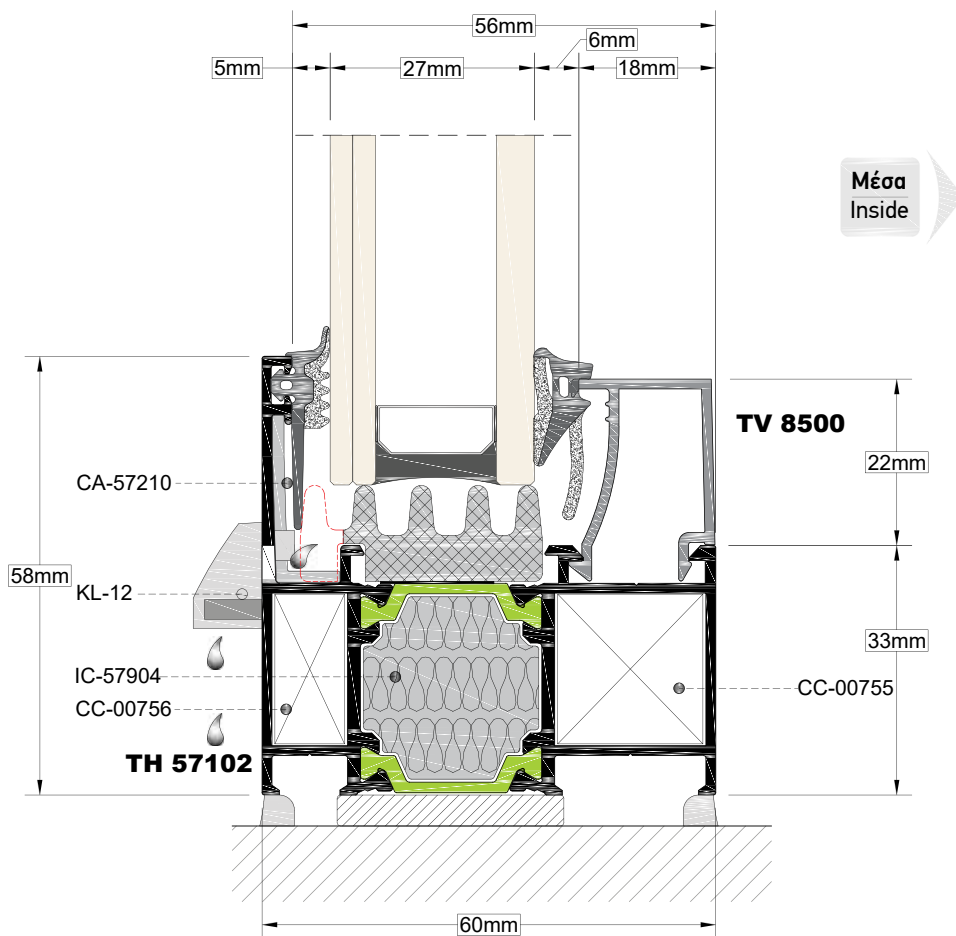
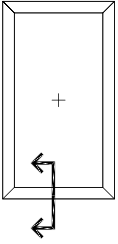



TOMH SECTION **6** ΚΑΙΜΑΚΑ SCALE 1:1

